

# LOG TRUCKER

VOLUME 44 NUMBER 8

To Advertise Call (800) 462-8283

AUGUST 2017



**Brooks Truck Show**  
25th Anniversary  
August 25 & 26  
Pacific NW Truck Museum  
Brooks, Oregon

**Leslie & Son**  
SUMNER, WA  
SINCE 1919



# FEATURED IN THIS MONTH'S ISSUE

## LESLIE AND SON

Nik Leslie has a collection of **five trucks** that he keeps on his **rhubarb, pumpkin and corn farm** in Sumner, Wash. Leslie spends his spare time restoring the trucks and attends **six truck shows and parades** a year with his trucks.

## SUMNER, WASHINGTON

**Sumner** is located in **Pierce County**, Washington near **Tacoma** and has a population of just under 9,700. After settlers had first arrived in 1853, **Sumner was platted in 1883** and was named after 19th century **US Senator Charles Sumner**. Agriculture remains a big part of the town's economy as its located in a fertile river valley.

## IN THIS ISSUE



**ON THE FRONT:** Nik Leslie poses in front of his 1980 Kenworth W900 out on his farm in Sumner, Washington. Leslie has been collecting and restoring classic trucks since the late 90s and the results are astonishing.

See "The Truck Farm" starting on Page 4

### 4. THE TRUCK FARM

LESLIE AND SON *by Brandon Hansen*

### 10. RANDOM TRUCK SHOTS

WHO KNOWS?

### 19. ADVERTISERS INDEX

WE'VE GOT WHAT YOU WANT

## LIKE WHAT YOU SEE IN LOG TRUCKER?

Buy a Subscription so you don't miss a single issue:  
**[www.loggersworld.com](http://www.loggersworld.com)**

## LOG TRUCKER

*Founded in 1975 by Finley Hays*

*Published by*

LOGGERS WORLD LLC

Phone **(360) 262-3376**

PUBLISHERS.....Kevin & Nancy Core

EDITORS EMERITI.....Finley Hays, Mike Crouse

EDITOR/WRITER.....Brandon Hansen

ADVERTISING.....Kevin Core

OFFICE MANAGER.....Nancy Core

POSTMASTER: Send address changes to:

LOGGERS WORLD LLC,  
P. O. Box 1631, Chehalis, WA 98532-8425

E-Mail: [logworld@aol.com](mailto:logworld@aol.com)

SUBSCRIPTION RATE (In U.S.A.):  
\$25.00 per year; Two years for \$50.00

LOGGERS WORLD LLC cannot and does not assume responsibility for the contents of any advertising in Loggers World. The representations made by advertising is the responsibility of the advertiser and not Loggers World. Loggers World does not knowingly accept advertising that is false or misleading. The limit of Loggers World liability in case of a mistake made in advertising copy by Loggers World will be the charge of the actual space containing the error or less for that particular advertisement





## ★ GENERAL TRAILER ★

*Building the Best...Repairing the Rest.*

Turn your dreams into reality with a call to the GENERAL today at 1-800-452-9532, to make this new Ranco 16-ft "Anvil" Rock Body yours!

**Thank You, Brian Gould of Coos Bay Timber**



**Purchased New GENERAL Dump Body**

Coos Bay Timber, located in Coos Bay, OR is pursuing its American dream by purchasing equipment it can count on, like this new GENERAL Dump Body. Thanks, Brian!

**Thank You, Paul and Robert Wampler Logging**



**Got new GENERAL Long Logger w/Quick Change Eqpt.**

Successful dreams are all about results. That's why Paul and Robert Wampler Logging, located in Klamath Falls, OR purchased this new GENERAL Long Logger with Quick Change Equipment, a strong investment in their business and their dreams. Thanks, Paul and Robert!

**New Ranco ED26-34 End Dump**



**In Stock! Only \$42,500**

Make your business dreams happen with the road-proven design and capabilities of this New Ranco ED26-34 End Dump that you'll find at the GENERAL today!

**Call the General's Headquarters.**  
**1-800-452-9532**

# GENERAL TRAILER

## Building YOUR American Dream

**New Ranco "Anvil" Rock Body**



**Only \$21,000** Includes FET

**New Felling XF-70-2 35-Ton Lowboy**



**Reduced! Only \$48,500**

**8' 6" X 22' Flat Deck, Great Equipment Trailer**

Rugged equipment keeps you on the road, in business, and building your American dream. Check out the best at the GENERAL, like this new Felling XF-70-2 35-Ton Lowboy.

**Used GENERAL Tandem Axle Hydraulic Booster**



**In Stock**

We're a partner with you in building your American dream. It's why we offer quality equipment for you, like this used Tandem-Axle Hydraulic Booster at the GENERAL.

**New 2017 and 2018 Peerless 53 Ft. 4-Axle Drop Center Chip Vans in Stock**



**New in Stock**



**Peerless Live Floor Trailers**

**Call Jerry for a Blowout Quote Today!**

**Call Jerry Blair in Oregon City 1-800-452-9683**



## AUGUST PARTS SPECIALS



270 Air Hitch Rear Mount	\$305.50 Ea
270K Parts Kit for 270 Hitch	\$110.50 Ea
270 6-Bolt Air Hitch Mount	\$355.50 Ea
580 Pintle Hitch 4 Bolt Mount	\$302.50 Ea
580K Repair Kit for 580 Hitch	\$150.50 Ea
501 Bolt Kit (260,270,1200,2200)	\$19.95 Ea
502 Bolt Kit (306,370&B,2700&B,C)	\$30.50 Ea
507 Bolt Kit (290,480,580,590,690)	\$23.50 Ea

### Valves

110000 Sealco Relay Valve	\$61.50 Ea
170000 Sealco Basic Control Valve	\$33.50 Ea
110500 Sealco Springbrake Control Valve	\$45.50 Ea
110200 Sealco Ratio Relay Emergency Valve	\$88.50 Ea
110700 Sealco Springbrake Valve Service Priority	\$54.50 Ea



### Air Tanks

2000 Air Tank 8-3/16" Dia. 1423 C/I	\$58.95 Ea
2001A Air Tank 9-11/16" Dia. 1468 C/I	\$55.95 Ea
2002A Air Tank 12" Dia. 2800 C/I	\$82.95 Ea
2002B Air Tank 12" Dia. 2 Valve Ports 2800 C/I	\$89.95 Ea
2130 Air Tank 8"x 26" Dia.	\$57.95 Ea

### Gladhands

441015 Sloan Service Gladhand Blue	\$2.89 Ea
441016 Sloan Emergency Gladhand Red	\$2.89 Ea
441017 Sloan Universal Gladhand	\$2.89 Ea
441721 Sloan Gladhand Pacifier 1 Ea	\$1.54 Ea
441737 Red Poly Gladhand Seal	\$62 Ea
441738 Blue Poly Gladhand Seal	\$62 Ea
441004 Service Gladhand Shutoff Blue	\$29.95 Ea
441014 Emergency Gladhand Shutoff Red	\$29.95 Ea



148847 S/S Quarter Fender Kit	\$149.95 Pair
150047 Poly Quarter Fender Kit	\$74.95 Pair
1500P 8" Post Mount Kit	\$7.95 Each



NOTE: NOT ALL ITEMS ARE IN STOCK AT ALL LOCATIONS. HOWEVER, WE WILL BE HAPPY TO TRANSFER INVENTORY TO THE BRANCH NEAREST YOU.

**Visit [generaltrailerparts.com](http://generaltrailerparts.com)**

### SPRINGFIELD

1420 South B Street  
Springfield, OR 97477  
Phone: (541) 746-8218  
1 (800) 452-9532  
Fax: (541) 726-4707

### MILTON

7200 Pacific Highway East  
Milton, WA 98354  
Phone (253) 926-8903  
1 (800) 562-8380  
Fax: (253) 926-8908

### OREGON CITY

21195 S. Highway 99 E.  
Oregon City, OR 97045  
Phone: (503) 263-2702  
1 (800) 452-9683  
Fax: (503) 266-9498

### REDDING

5875 Eastside Road  
Redding, CA 96001  
Phone: (530) 246-3813  
1 (800) 475-1057  
Fax: (530) 246-3823



# The Truck Farm

**Nik Leslie grows rhubarb for a living, but his real passion is restoring classic trucks**

Story by Brandon Hansen  
Photos by Kevin Core  
*For Log Trucker*

Sumner, Washington farmer Nik Leslie likes trucks.

He likes trucks so much that they've turned into a hobby for him. Actually that would be an understatement. Trucks have turned into a collection for him.

Leslie has five A-model Kenworths with long hoods and a Peterbilt 359 that have been restored. He keeps them all around his western Washington farm, sharing shop space to stay out of the weather and working on them with friends during the weekend and the farming off-season.

The Leslie Family immigrated from Scotland in the early 1900s and instead of coming through New York, they took a route through Canada and then down into the states through Vancouver. Nik's great grandpa started a rhubarb, hops and berries farm in Sumner in 1919 while also doing masonry work.

The family did so much masonry work, that his granddad added a brickyard on the farm



and that lasted until 1988. The farm continued to grow and as a kid Nik began working in the farm's shop learning to work on trucks and equipment.

With his dad Ron driving truck, Nik would get up early and come out to the truck to ride out into the woods. After one load of logs in the woods, they would stop by a general

(Continued on Page 5)  
**See "Leslie"**

## SIDE BY SIDE

Here are two parts of Nik Leslie's truck collection - a blue 1976 Kenworth W900 (also known as the "Queen Mary") and a black 1980 Kenworth W900 - parked undercover at Leslie and Son farm in Sumner, WA. Nik drove truck for several years before coming back to the family farm. Leslie kept his interest in trucks and actually began working on them on the side. Then in 1998, he got his first truck, and then another, and another. (I'm sure several people reading this magazine are aware of this phenomenon.)

**G. W. GANNON EQUIPMENT**  
31914 ROLLAND DRIVE  
TANGENT, OR 97389  
(5 MILES SOUTH OF ALBANY) **(541) 928-5244**



1992 KW T-800, N-14 Cummins, 13 spd. with 2 spd. rear ends on pad suspension



1992 KW T-800, N-14 Cummins, 15 spd. with 2 spd. rear ends on pad suspension

**PRICES  
REDUCED  
\$35,000  
Each**



**GEAR BOX Inc.**

TRANSMISSION & DIFFERENTIAL REBUILD & REPAIR

1037 State Street (Exit 79 off I-5) • Chehalis, WA.

8:00 a.m. - 5:00 p.m.  
Monday - Friday

**(360) 748-8350**

**Let us Lower Your Cost Per Mile  
with our  
High Quality Time & Material Rebuilds**

★ FULLER  
★ EATON  
TRANSMISSIONS  
TRANSFER CASES  
★ SPICER  
★ ROCKWELL  
DIFFERENTIALS  
AUXILIARIES

Complete Time &  
Material Rebuild  
Unit Comes with a  
**1 Yr. Unlimited  
Mileage Warranty**



*We Pride Ourselves on Genuine OEM Parts*

**CUSTOM BUILD or EXCHANGE**



## Leslie

(Continued from Page 4)

store to get a berry pie. Nik remembered one time he had fallen asleep and thought they hadn't picked up a berry pie. He said he was visibly mad at his dad, but after several minutes of a quiet drive up a logging road, Nik eventually noticed his dad had put the berry pie on his seat while he was sleeping.

After Nik graduated from

high school and started driving flatbed trucks, highway trucks and frozen meat trucks. After he met his wife, Heidi, he decided he wanted to be home with his family rather than on the road. Nik returned to the family farm of 200 acres and grew corn, pumpkins and rhubarb.

Leslie kept his interest in trucks and actually began working on them on the side. Then in 1998, he got his first truck, and then another, and another. (I'm sure several people reading this

magazine are aware of this phenomenon.)

Today his collection consists of a 1980 Kenworth W900, a blue 1976 Kenworth W900 with Gordon Fast Freight on the door, a black 1974 Kenworth W923, a 1982 Kenworth and a 1986 Peterbilt 359.

The blue Gordon Fast Freight truck was seen by Leslie eight years ago. He had seen Gordon Fast Freight trucks on the road before, and it took him four years to restore it to his former

glory.

"When I was a kid, I would watch these things go down the road and I just thought these were the coolest things," Nik said. "Most of the trucks are from the 70s because those are the ones I remember going down the road."

Word of the restored truck got back to Gordon Fast Freight CEO Larry Gordon. He called

(Continued on Page 7)  
**See "Leslie"**



# Betts®

## TRUCK PARTS & SERVICE

Earning Your Trust, Mile after Mile®

# STEER AXLE ALIGNMENT

## August SPECIAL

**\$79<sup>95</sup>**  
~~\$125~~

### SHOP SERVICES

LASER ALIGNMENT  
STEERING REPAIRS  
AXLE SLEEVEING  
SUSPENSION REPAIRS  
LEAF SPRING NEW/REPAIR  
BRAKE/WHEEL END REPAIR  
DRIVETRAIN REPAIR  
TRAILER CHASSIS REPAIR  
WELDING WORK  
50-POINT INSPECTIONS  
DOT INSPECTIONS  
PRESS WORK  
CUSTOM U-BOLTS  
FLYWHEEL TURNS  
DROP AXLE INSTALLATION

**DROP IN - NO APPOINTMENT NEEDED BEFORE NOON!**



**SUSPENSION EXPERTS OFFERING A FULL LINE OF TRUCK PARTS**

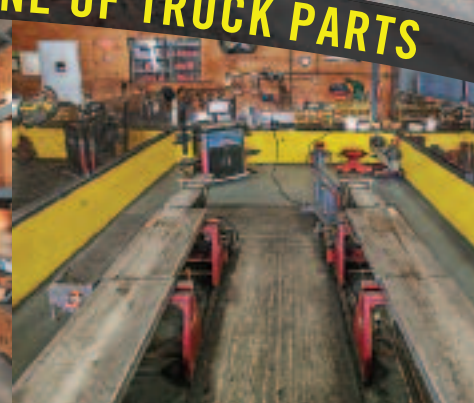

**WE PROUDLY INSTALL  
& SELL OVER 150 TOP  
BRANDS!**

**HENDRICKSON** **Bendix**

**OUTCO**  
Hutchinson Industrial

**PORTLAND**

NE Columbia Blvd.



NE Portland Highway NE 42nd Ave.

**Betts Truck Parts & Service**

4334 NE Columbia Blvd.  
Portland, OR 97218

**503.289.8875**

**BettsTruckParts.com**

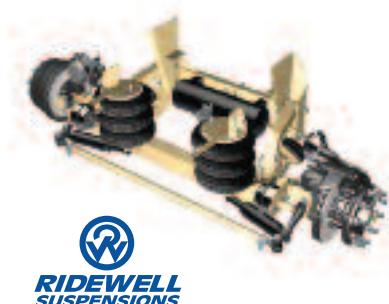





## SHOWING OFF

This Kenworth 1976 with Interstate Distributing colors is a friend's truck that Nik Leslie's has worked on (left). Leslie hosted a truck show at his farm in Sumner in the past, inviting many people's makes and models to be showcased at his rhubarb, corn and pumpkin farm (above).



## Advanced Hydraulic Supply

4444 N.E. 148TH Avenue, Portland OR, 97230

**1-877-887-1730 • (503) 289-0354**

**FORESTmaster** 

**SUPERIOR PERFORMANCE  
HOSE ASSEMBLIES FOR  
FORESTRY MACHINES**



- Superior Abrasion Resistance
- Improved Service Temperature to -46° C (-50° F)
- High Flexibility
- High Tensile "Textile" Braid Layer

 <b>SCHOTT</b> PARTS & ACCESSORIES <b>503-463-0500</b> CALL FOR OUR CATALOG!	<b>I-5 Exit 263</b> 8983 TRUCKMAN WAY SALEM, OR 97303 SHOWROOM HOURS Monday-Friday: 8:00-5:30 Saturday: 9:00-1:00
	Summer Saturday Hours 9-1 <b>WWW.TRUCKCHROME.COM</b>

**Come join us at the  
Brooks Truck Show!**  
**Friday 8/25: Nightglow at 9pm**  
**Truck Show Saturday 8/26**

• PRIZES • TROPHIES • FUN!  
 All proceeds go to Charity!

*Your Home for Chrome!* • BUMPERS • STACKS • LED LIGHTS  
 • CHROME • FLAPS • FENDERS



Leslie and came out to see his former truck.

"A fancy car came to the farm, he stepped out and then began looking at the truck and walking around it," Nik said. "He began taking photos of it and telling stories about the truck. A friend of mine told me when Gordon got back to his shop, he was still talking about the truck."

Leslie also got a black and gold 1980 Kentworth W900 that Pat Wedrick had bought brand new. He got it in 2004 on a trip

to Walla Walla.

"I was driving with my wife and we saw it on the side of the road and I knew I wanted to take a look at it," Leslie said. "My wife said we have to get to Walla Walla so I just made sure we had enough time to look at it on the return trip."

It was in rough shape, but a week later he owned the truck.

After restoring it, Leslie had it up at the Morton Loggers Jubilee and a person there saw the truck and said he knew the guy that previously owned it. After a phone call, Nik exchanged serial numbers and the previous owner

ended up showing him old photos of him with the truck and a folder of paperwork from Kenworth Motors for the truck.

"I was just blown away," Nik said."

The black 1974 Kenworth W923 was previously owned by a friend. It had a 1693 CAT - one of the first engines they put in trucks. The friend was going to part it, but Leslie conned him into selling it.

Leslie also got a 1982 Kenworth out of Ellensburg and his Peterbilt he got out of Florida after it had served years as a big highway truck.

Now how does Leslie find time to work on his trucks? He finds bits of time here or there during the end of days or in the farming offseason. On weekends he will get a bunch of friends together and they'll just start "picking" on the truck.

"It's a great stress reliever and helps me unwind," Nik said.

To find parts, Leslie has to shop around and see if he can find rare pieces. There are still aftermarket parts available but he has to go after them. For some

(Continued on Page 8  
**See "Leslie"**

Check out our 2017  
line of dump boxes  
Call for a quote today!



We manufacture & service  
Lincoln Log Trailers  
Parts & Service Shop  
available for most brands



Monday – Friday 7:30 – 4:30  
Saturday 8:00 – 2:00  
4130 Tumwater Truck Route,  
Port Angeles 98363  
1-800-492-6122 / 1-360-457-6122  
[www.lincolnindustrialcorp.com](http://www.lincolnindustrialcorp.com)  
YouTube Like us on Facebook



We offer welding services and  
general welding supplies,  
plasma cutting,  
stock steel, and propane



Auburn  
Office  
Wayne Kinberg  
1-888-212-0514  
1-360-461-3795



Flat Beds,  
Tilt Beds,  
Hooklifts,  
Truss and  
Tilt Trailers





(Continued from Page 7)

pieces, he has to have them custom-made by machine shops.

He also has to have a shop custom-make the dashes since time has taken their toll on them. Luckily, he's been able to replicate the wood grain pattern in the truck dashes from the 70s.

To do custom lettering and gauge graphics, Leslie turns to Alisha Jennings of Spanaway. She also does custom stickers for the trucks that would be on it.

"She's very talented and does great work," Nik said. "She even puts part numbers on the stickers because back then even the stickers were considered parts."

She even came up with the original shift pattern sticker.

Leslie makes about six truck shows and parades a year. With friends and family he's able to take all six trucks. Sometimes when he heads down to Chehalis, Wash. for farm reasons, he tries to haul fertilizer with his trucks just to keep them working.

He loves taking his trucks to ride and finds a reason to have them haul a camp trailer, haul a trailer for a company that works at fairs and sometimes he just hops in the trucks for a Sunday afternoon drive.

"I also enjoy meeting new people," Nik said. "The internet is great and you can find a lot of people with similar interests in trucks. I've made a lot of friends that share the same interest that I do."

Nik said he has a very understanding wife Heidi who lets him collect and work on trucks.

"This is how I relax and I wouldn't be able to do it without the support from her," he said.



## IN PROGRESS

A Peterbilt 389 - Nik Leslie's latest project - sits behind its CAT 3406B engine at the Leslie and Son farm in Sumner, Wash.

# ST. JOHNS

## THE POWERTRAIN PEOPLE

## TRUCK & EQUIPMENT



### REBUILT TRANSMISSIONS/ REAR ENDS

(ALL SOLD EXCHANGE)



### FREE FREIGHT!

St. Johns will pay the Freight to you on any REBUILT TRANSMISSION or REAR END sold in Washington, Oregon, or Idaho

#### DIFFERENTIALS - ROCKWELL

PRICES VARY BY RATIO, ALL PRICES STARTING AS LOW AS...

RD20-145	\$2,140.00
RR20-145	1,240.00
RDL20-145	2,615.00
RRL20-145	1,765.00
RD23-160	3,165.00
RR23-160	1,865.00
RDL23-160	3,715.00
RRL23-160	2,440.00
SQHD	1,965.00
SQHR	1,610.00
QD100	1,750.00
QR100	1,190.00
SSHHD	2,215.00
SSHR	1,390.00

#### EATON:

DT461P	\$4,650.00
RT461	3,050.00
DD461P	4,915.00
RD461	2,800.00
DS461P	3,425.00
RS461	1,800.00
DS402	1,800.00
RS402	1,175.00
DS404	1,700.00
RS404	1,150.00
DT402	2,875.00
RT402	1,950.00
DD404	2,825.00
RD404	2,050.00
DSH40	2,300.00
RSH40	1,575.00
DDH40	3,550.00
RDH40	2,200.00

Many Other Transmissions And Differentials Available... Call Us First!  
Custom Repair For Your Unit  
**CALL US FIRST!**

#### CUMMINS® MANIFOLDS

3801322 855 LARGE PORT	\$325.00
3801915 855 SMALL PORT	295.00

#### FLYWHEEL HOUSINGS

CUMMINS® FW HOUSINGS	CAT® FW HOUSINGS
3680063 ISX	\$795.00
3036005 855/N14	399.00
1302802 3406E	\$1295.00
1694153 C15	1795.00

#### REPLACEMENT FLYWHEELS



CUMMINS FLYWHEELS		
3071535	855/N14.....	\$435.00
3016495	855.....	375.00
CAT FLYWHEELS		
9L6392	3208.....	\$425.00
9Y9313	3208.....	399.00
4P4797	3406.....	465.00
DETROIT FLYWHEELS		
23509709	SERIES60	\$450.00

#### FULLER

RT/RT06613	\$3,075.00
RT8609A	3,150.00
RT012513	2,550.00
RT012515	2,350.00
RTX12609B	2,325.00
RTX14609B	2,400.00
RT014613	2,625.00
RTLO14613BP	3,350.00
RTX14708LL	2,600.00
RTX14710B/C	2,700.00
RTX14710B/CP	2,900.00
RT14715	3,200.00
RT015613P	3,000.00
RTX15710B/CP	2,900.00
RT0/RTX15715P	3,300.00
RTX16710B/CP	2,900.00
RTAO16710B/C	4,000.00
FRO16210B/C	3,395.00
RTLO16610BP	2,925.00
RTLO16618A	3,550.00
RTLO14713A	3,125.00
RTLO16713A	3,600.00
RTLO16718B	3,900.00
RTLO16913A	3,600.00
RTLO16918B	4,150.00
RTLO18718B	4,150.00
RTLO18913A	3,895.00
RTLO18918B	4,395.00
RTLO20913A	4,675.00
RTLO20918B	4,875.00
RTLO22918B	6,550.00

#### ROCKWELL

RMX10-145A	\$3,465.00
RMX10-165A/C	3,415.00
MO16G10C	3,915.00

#### POWERSTEERING PUMPS / GEARS

##### PUMPS

- Eaton
- Parker
- Vicker
- Saginaw
- ZF
- TRW

##### GEARS

- Ross/TRW
- Saginaw
- Bendix
- Gemmer
- Sheppard



Same Day Shipping!

### EATON/FULLER TRANSMISSIONS



Eaton/Fuller Transmissions now come with a TWO YEAR UNLIMITED MILEAGE WARRANTY.

- All Eaton/Fuller Transmissions are dyno tested.
- Our Fuller Transmissions are remanufactured using genuine OEM overhaul kits, gearing, synchronizers and air systems. We are one of the few rebuilders in the nation using all OEM parts in our Fuller transmissions.

### Fuller 18 speeds

NEW



Built with 100% NEW OEM gearing  
RTLO18918B ...\$6895.00 exchange  
RTLO20918B .....7295.00 exchange  
RTLO22918B .....7695.00 exchange

Call for outright pricing and exchange details

**FULL SERVICE TRUCK & TRAILER REPAIR**  
**Call St. Johns First!**

8435 N. CRAWFORD STREET • PORTLAND, OREGON 97203

NATIONWIDE TOLL FREE:

**(800) 222-8435**

PORTLAND:

**(503) 286-8336**

FAX:

**(503) 283-3423**







## BLACK AND GREEN

Leslie also got a black and green 1974 Kenworth W923 that Pat Wedrick had bought brand new. He got it in 2004 on a trip to Walla Walla. "I was driving with my wife and we saw it on the side of the road and I knew I wanted to take a look at it," Leslie said. "My wife said we have to get to Walla Walla so I just made sure we had enough time to look at it on the return trip." It was in rough shape, but a week later he owned the truck.

Pickup  
in Oregon

**NO SALES TAX!**

**We Do  
Limited Installs  
Like for Like**



**CAT  
C-15  
6NZ**

Several  
Single  
Turbos,  
Super  
Conditon

Low Miles, **CALL!**

**We Buy**

**Running, Wrecked,  
End of Life Trucks,  
and Stand Alone  
Parts, Too!**

**DETROIT SERIES "60"**



Dedec III, IV & V Engines Available,  
With Jakes, Good Condition



We are your  
**NORTHWEST HEADQUARTERS**  
for 46,000-lb. **ROCKWELL MERITOR &  
EATON TANDEM REARENDS**  
all ratios, all suspensions, rebuilt gearheads  
& parts available - **CALL NOW!**

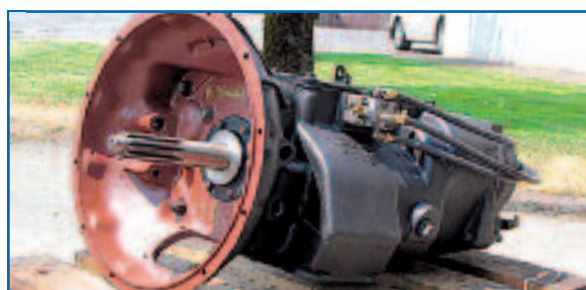

### REBUILT TRANSMISSIONS

RTO-14713	....\$3,100	RTO-16915	...\$2,650
RTO-16713	....\$3,300	RTLO-16618	...\$3,200
RTO-16913	....\$3,500	RTLO-16718	...\$3,850
RTO-18913	....\$3,750	RTLO-18918	...\$4,350
RTO-14715	....\$2,750	RTLO-20918	...\$4,625



**WHOLESALE TRUCK PARTS & EQUIP.**

Nationwide & Canada

**1-800-547-1315**

5925 N.E. Portland Highway, Portland, OR 97218

HOURS: 8:00 - 5:00 Monday thru Friday

FAX# 1-503-288-6337 • DELIVERY AVAILABLE

**503-288-6333**



# RANDOM TRUCK SHOTS

Have a photo of your truck?  
Send it to  
[kevin@loggersworld.com](mailto:kevin@loggersworld.com)



## 1980 MARMON

This is a 1980 Marmon powered by a Deutz V-12 air cooled engine and also has an air ride front axle. During the 80s and 90s this truck hauled many logs and poles. And still found time to show and shine at numerous parades. Then the spotted owl issue began and she was retired. 20 some yrs later Mike Rotschy pulled her from the bushes and between him and the original driver Charlie aka Chatatchie Apache they began to give her back life. Still a work in progress. Her new job is to escort the "Bull of the Woods" thru our Amboy parade and into the logging arena to receive his award.





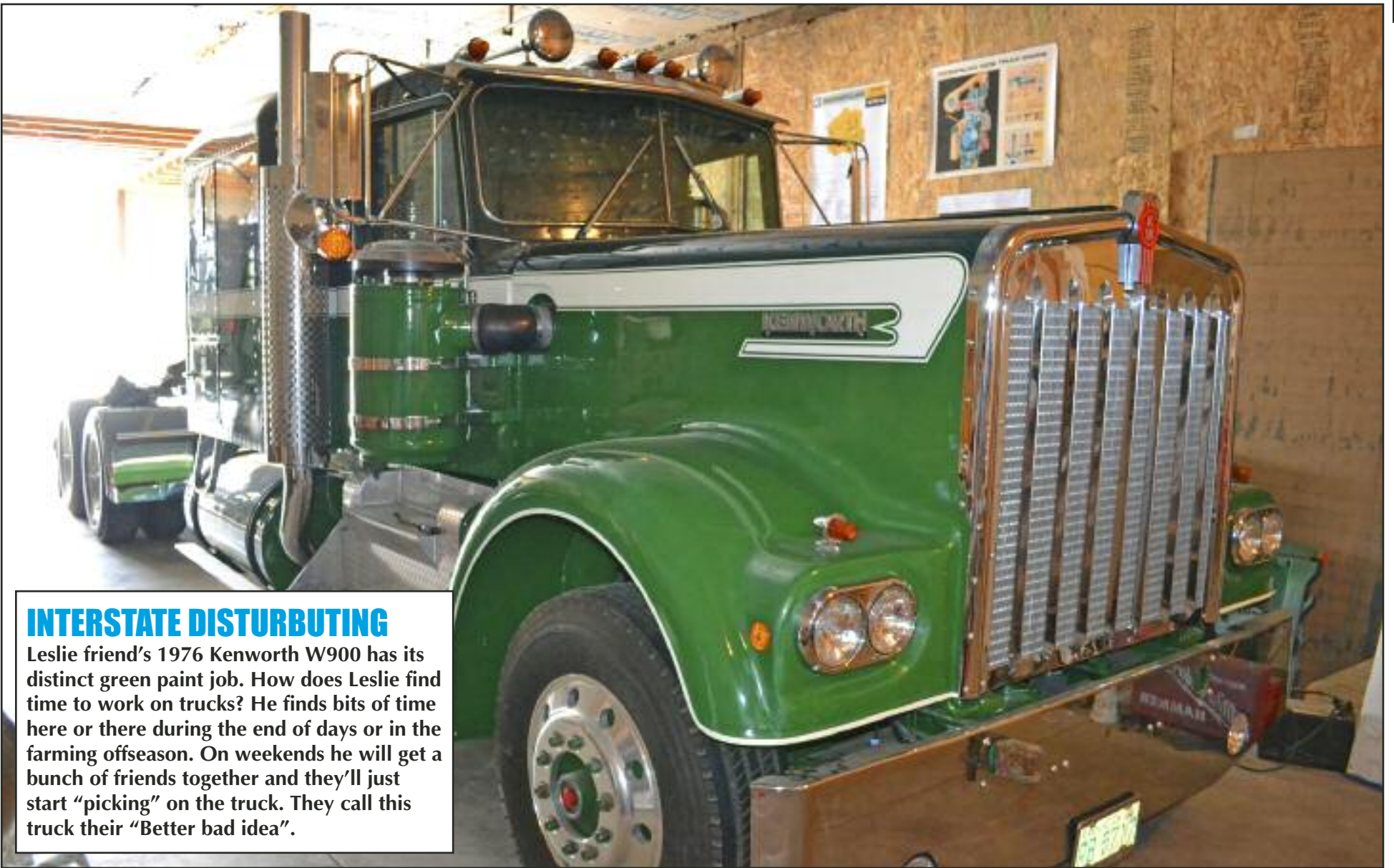

### INTERSTATE DISTURBUTING

Leslie friend's 1976 Kenworth W900 has its distinct green paint job. How does Leslie find time to work on trucks? He finds bits of time here or there during the end of days or in the farming offseason. On weekends he will get a bunch of friends together and they'll just start "picking" on the truck. They call this truck their "Better bad idea".



**Let Us  
Build You  
a BRAND NEW  
ALPINE Trailer**

or call us for an appointment to  
service your existing trailer



**It's Hot and Dry**  
Let's be careful out there

**ALPINE**  
INDUSTRIAL, LLC  
LOG TRAILERS

**CALL (208) 877-1714**

2810 Big Bear Ridge Road • P.O. Box 341, Deary, ID 83823

Fax: 208-877-1198 • email: [alpineindustrial@moscow.com](mailto:alpineindustrial@moscow.com)





**LOOKIN' SHARP**

To do custom lettering and gauge graphics, Leslie turns to Alisha Jennings of Spanaway. She also does custom stickers and pinstriping for the trucks as well.



Call (800) 422-0074 or join  
online at [www.loggers.com](http://www.loggers.com)

**Membership Highlights...**

- Master Logger Program (exceeds SFI logger training requirements)
- Monthly Springboard Magazine
- First aid/cpr and pilot car training
- Log A Load For Kids® - giving campaign for Children's Hospitals
- WCLA Insurance Agency - top coverage for the timber industry
- Employee benefits programs through WCLA's benefits partner: Kibble & Prentice
- WCLA Claims Management Program - providing the benefit of savings on L & I premium costs, improved safety standards and reduced claims costs

**LOG AND PULP LOADERS**  
**Several Used Sercos Available**

**NEW SERCO 160PH POLE HANDLING PACKAGE IN STOCK**, lifts up to 110' poles

**2008 FORD F550 4X4**, 6.4 liter diesel, auto trans, 17,950 GVW, 9' - 6 compartment service body, 12,000# bumper winch, 50 gallon slip tank w/electric pump **STK. #5409**

**2008 PETERBILT 335**, PX8, 330 hp, Jake, 12,000# front, 21,000# rear, 11' service body, **National N65 Knuckle Boom**, 7000# capacity, 33' boom, remotes, 4400# winch, Miller welder, hyd driven air compressor **STK. #5374**

**2009 INTERNATIONAL 7400**, Max Force DT, 260 hp, Allison auto, 14,000# front, 40,000# rear, **2015 United 4000 Gal Water Tank**, self-loading, 2 front, 2 rear, 2 side sprays, rear hose reel **STK. #5085**

**NEW SERCO 160PH LOG LOADER**, 25' reach, 400° rotation, 46" continuous rotating grapple, 18,826# capacity, 10° off set jib **STK. #5329**

*Sold & Serviced by*



**L&M Truck Sales, Inc.**  
**4001 E. Boone Ave.**  
**Spokane, WA 99202**  
**800-796-9813**





## GLOWING GREEN

Alisha Jennings of Spanaway helped do the custom gauges for Leslie's trucks. LED lights give the gauges a green glow that give a nostalgic feel to these classic truck cabs.

# WHIT-LOG Trailers

P.O. BOX 668 • WILBUR, OR 97494

**WE ARE NOW ON FACEBOOK!**  
Check out all the pictures and  
Like Our Page!



[www.facebook.com/Whitlogtrailers.com](http://www.facebook.com/Whitlogtrailers.com)



**Cascade Forestry Inc.**, GOLD HILL, OR, Brand New 2017 Whit-Log NBSEW100 Long Logger with Matching Truck Equipment. Custom Aluminum Cab Rack, Double Tapered Quick Change Detach, and Much More... **Thanks Scott!!**



**Hadaller Logging Inc.**, KELSO, WA, (2) Brand New 2017 Whit-Log SEWC100 Long Logger with Matching Truck Equipment. Custom Steel Cab Rack, Double Tapered Stinger, and Much More... **Thanks Shawn!!**



**Hemmingsen Contracting CO Inc.**, CRESCENT CITY, CA, Brand New 2016 Whit-Log SEWC100 Long Logger with Matching Truck Equipment. Custom Aluminum Cab Rack, Quick Change Insert Stinger, and Much More... **Thanks Steve & Mike!!**



**K D Hobin**, PHILOMATH, OR, Brand New 2017 Whit-Log SEWC100 Long Logger with Matching Truck Equipment. Custom Aluminum Cab Rack, Double Tapered Stinger, and Much More... **Thanks Kurt!!**

**OFFICE: (541) 673-1166**  
EMAIL: [brett@whitlogtrailers.com](mailto:brett@whitlogtrailers.com)

**TOLL FREE 1-800-452-1234**  
[www.whitlogtrailers.com](http://www.whitlogtrailers.com)





## AT THE READY

The 1980 W900 runs a restored General trailer with custom pin-striping. After restoring the truck, Leslie had it up at the Morton Loggers Jubilee and a person there saw the truck and said he knew the guy that previously owned it. After a phone call, Nik exchanged serial numbers and the previous owner ended up showing him old photos of him with the truck and a folder of paperwork from Kenworth Motors for the truck.



## LOG TRUCKER VIDEO

Use your smart phone to download a QR Code app and scan this to see more video of Leslie and Son's truck collection.

**KNOX**
**DOUGLAS, INC.**

### NEW Silent Drive Ultra Flex Series UF-1013-1B

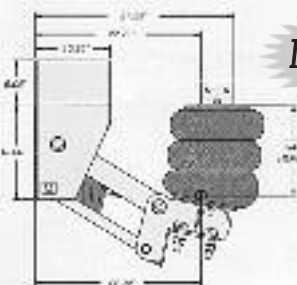
*In Stock Now !*

Pushers or Tag,  
Utilizes Steer  
Axle (Single  
Tire only)  
13,200 lbs  
Capacity

**With Rebuilt Axle or your Axle.  
Call for your Application**

Suspension and Air Parts in  
Stock and Available Now!



Authorized PULLTARPS Dealer.  
We carry parts and provide service  
for all your PULLTARPS needs

**SILENT  
DRIVE**

Suspension  
Component  
Group

**Pederson**
**FOR LOGGING OR DUMP TRUCKS**

### FENDER KITS

Spindle Mounted for Self Steering  
Auxiliary Axles. Available with  
instructions to install it yourself  
or we can do it for you.

Need a "Brake" on your Truck Insurance Rates?

**T.W. MORGAN INSURANCE SERVICES**

Since 1991 Insurance & Financial Services Brokerage Agency

"AN AGENT WHO UNDERSTANDS TRUCKING"

- Log Trucks • DOT Fuel Bonds
- Dump Trucks • Chip Trucks
- Tow Trucks • Sand & Gravel Trucks
- Truckers General Liability & Cargo Available
- Short & Long Haul Trucking • 50-500 miles to unlimited mile radius

**90% of Our Quotes  
Save Our Callers \$\$\$  
WHAT ABOUT YOU?**

Ask for Tim • 503-245-3345 or 888-821-4717 • Tigard, Oregon  
Serving Oregon, Washington & California

We Accept

P.O. Box 5701  
Salem, OR 97304



503-363-0892  
fax 503-362-5435

**WE SELL and  
INSTALL THEM!  
CALL US!**





**MILLER TRUCK SALVAGE L.L.C.**  
**DIESEL TRUCKS & PARTS**  
 15015 N. W. MILL RD. • PORTLAND, OR 97231  
**"Specializing in '70's thru 90's"**  
**(503) 283-1797**

**3408 CAT ENGINE**

Leslie's black 1980 Kenworth W900 sports its 3408 CAT. Leslie makes about six truck shows and parades a year. With friends and family he's able to take all six trucks. Sometimes when he heads down to Chehalis, Wash. for farm reasons, he tries to haul fertilizer with his trucks just to keep them working.



1995 T800, N14, 10-spd Fuller, Rockwells on AG 100 **Parting Out**



1997 CH600, E-7, 10-spd Spicer, Spicer rears **Parting Out**

1981  
W900A,  
BC3400,  
13 spd Fuller  
**Parting Out**



2005 VNL  
Volvo,  
18 spd  
Fuller, 46k  
Rockwell  
dbl lock  
**Parting Out**



1993 Volvo,  
low mile  
3406C Cat,  
13 spd  
Fuller, 402  
Eatons,  
**Parting Out**



2005 KW  
T600,  
C15 Cat,  
Fuller trans,  
404 on  
AG400  
**Parting Out**



**ENGINES / TRANSMISSIONS**  
**Check With Us Before You Buy!**

**TRANSMISSIONS**

• RT 6613 .....	\$1,250
• RT 6610 .....	\$1,250
• RTO 15613 .....	\$2,000
• RTO 14715 .....	\$1,500
• RTO 14613 .....	\$1,500
• RTLO 16713A .....	\$2,600
• RTLO 18718B .....	\$2,750

**ENGINES**

• 3406B 425 h.p. Inspected.....	\$5,000
(Uninspected)	
• 8.3 Cummins, mech. \$3500 exchange	
• 5.9 Cummins, runs good .....	\$2,750
• Cummins BC 1-4 series.....	3000-4500 exchange
• E-7 300 W/Jakes, good runner .....	\$4000
• 675 285 hp., low miles .....	\$3500
• 3406E 5EK- 2WS. 4000-6000 exchange	
• DDEC4 450hp., runs good .....	\$5000

**EXCHANGE REQUIRED ON SOME EQUIPMENT - CALL FOR SPECIFIC UNITS**

**CABLE-LITE**  
**LOGGING WRAPPERS**

THE HIGH-TECH  
REPLACEMENT FOR  
WIRE ROPE WRAPPERS

**Reduce Shoulder  
Injuries**

✓ 3 times lighter than equivalent  
strength wire rope

**Reduce Hand  
Injuries**

✓ No "jaggers" to tear up your  
hands

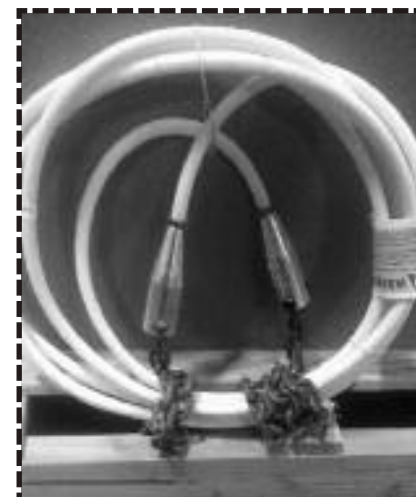

Cable-Lite Logging Wrappers have been field tested and proven to provide a lightweight, ergonomic replacement to the standard wire rope wrappers. Cable-Lite Wrappers meet or exceed all Federal and State regulations and are labeled for easy inspection.

**HARBOR**  
**Saw & Supply** inc.

3102 Simpson Ave. in Hoquiam!  
**800-786-6463 • (360) 532 4600**





## LOOKING FOR PARTS?

To find parts, Leslie has to shop around and see if he can find rare pieces. There are still aftermarket parts available but he has to go after them. For some pieces, he has to have them custom-made by machine shops. He also has to have a shop custom-make the dashes since time has taken their toll on them. Luckily, he's been able to replicate the wood grain pattern in the truck dashes from the 70s. Here is Nik's desk with a collection of truck parts behind it. By the way, we think Nik has superb taste in reading material.

AFTERMARKET • NEW OEM  
USED PARTS • HOODS

**I-5 & Exit 59 Toledo, WA**  
Monday to Friday  
8-4:30pm



**Washington  
Truck Rebuilders**  
www.washingtontruckrebuilders.com

TRUCK • TRAILER • COLLISION  
FIBERGLASS REPAIR

**1-800-373-3719**

wtr@toledotel.com

### AUGUST SPECIALS

**8 Used  
24.5 Bud  
Steel Wheels  
& Tires**  
**\$100<sup>00</sup>**  
each

**NEW CUMMINS  
ISX 450 TIER 1 ENGINE**



**\$23,500**  
Exch.

**2005 Pete 378**



Cat C15, 13sp., 450K miles  
**\$28,000**



**Gorilla Hoods**

Over 350 New, Rebuilt &  
Used Hoods in Stock!  
We are your Hood Specialists!

**HOOD NEED REPAIRED? CALL US FOR A QUOTE!**



"take out"  
**Cummins N14  
Celect**

430HP CPL 1573

**\$5500** no ECM exch.



View Our Aftermarket Hoods Online @ [www.washingtontruckrebuilders.com](http://www.washingtontruckrebuilders.com)



## INTERIOR

Leslie is a stickler for detail and tries to restore the inside of his trucks to their original condition complete with authentic stickers, wooden dashes and of course, all the switches.

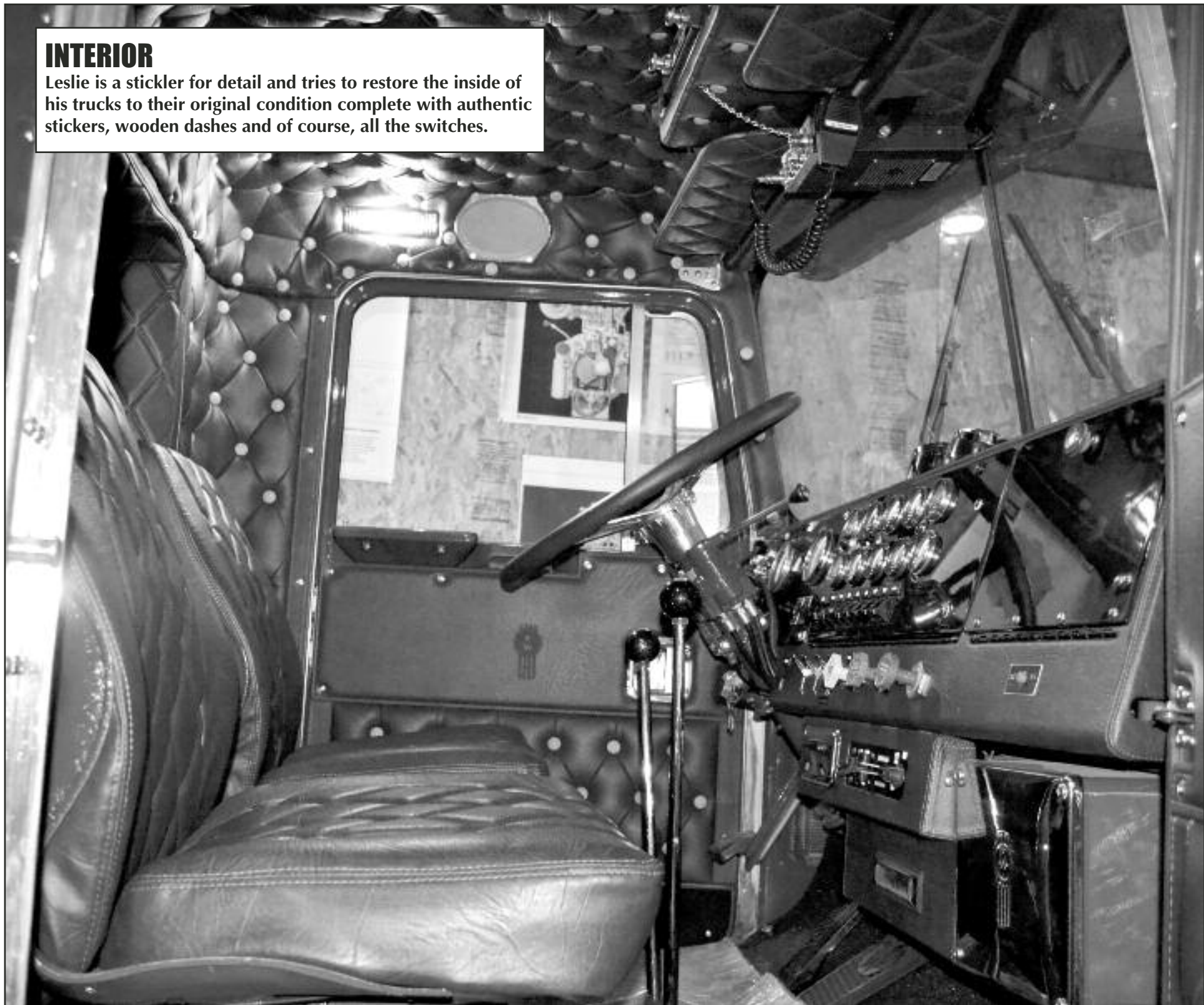

### HEAVY DUTY TRANSAXLE

16891 146th St. SE Suite 103 Monroe, WA 98272  
360-794-2021 Toll Free: 888-383-3301  
Hours: 8:30am to 4:30pm

**Exchange Units in Stock**  
**Differentials in Stock**  
AxleTech, Clark, Eaton,  
Fuller, Meritor, Spicer

**Full line of Planetary  
Service Parts**  
AxleTech, Clark, Rockwell, Shuler  
Fits: Washington/ Skagit/  
Thunderbird/Madill Yarder Axles  
& More



**Local Full Service Gear Shop**  
Custom Gearwork  
Time & Materials

**Caterpillar Drill Undercarriage**  
4 with 3 bar grouser  
2 with single bar grouser

D4 or D5 Tracks  
6.75 in (171.05 mm) Pitch  
8 Bottom Rollers  
Rexroth Drive Motors  
Idlers and Sprockets

3 Sets available. Ready to Install!

### Units In Stock!

New & Rebuilt

20145 Rear Rear  
20145 Rear Lockers  
20145 Front Lockers  
23160 Front Lockers  
23160 Rear Lockers  
Ratio's available: 4.10, 4.30,  
4.56, 4.89

DS461 RS461  
DD461 RD461  
DC461 RC461

RTLO20918B RTLO18918B  
RTLO18718B RTLO16713A  
RTO14613IP RTO14613  
RTLO16915 RTLO15715  
RTLO14715 RTLO14709  
RTLO16908MEL

### SPICER/DANA

1241C / D - REBUILD EXCHANGE  
AMO 1104-C / D  
AT1202 AirShift / Mechanical

**Call us for current stock!**



**AxleTech<sup>®</sup>**  
International

### New Core-Free Assemblies

RR20145  
RRL20145  
RD20145TL

**In stock - Ready to Ship!**

Authorized Distributor for AxleTech International

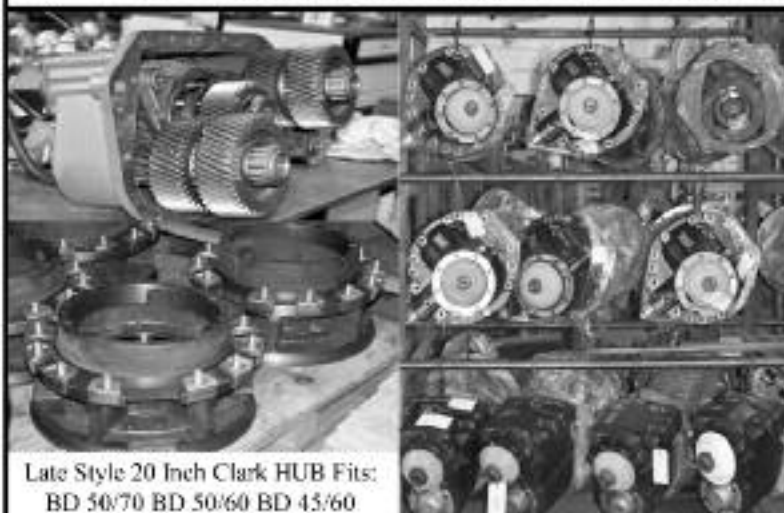

Late Style 20 Inch Clark HUB Fits:  
BD 50/70 BD 50/60 BD 45/60





# INTERIOR

Leslie's Blue 1976 Kenworth W900 (Also known as the "Queen Mary") sits next to the black 1980 Kenworth W900. The black 1980 Kenworth W900 was previously owned by a friend. It is now powered by a 3408 Cat engine that's so clean you could eat off it. The friend was going to part it, but Leslie conned him into selling it. There are lots of details on Leslie's trucks, including the lugnuts (left)



## WE OFFER:

- General Truck Repair
- Complete Diesel Engine Service
- Hendrickson Rebush Center

Incl. Hendrickson 380 Series Equalizer Beams

We Rebush Log Trailers  
CHALMERS & 8-BAG  
KENWORTH SUSPENSION  
REBUSHES

### Stop By Our Shop

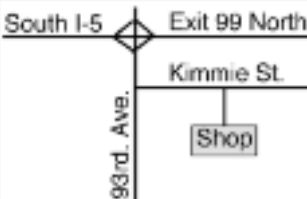

COMPLETE  
LOWER  
REBUSH

**\$1575**

Bar Pins Extra

Usually in 3 Hours or less  
Call For Appointment



## SCHELLER DIESEL SERVICE

9144 Kimmie Street - Olympia, WA. 98502 • (360) 943-9818



# LOG TRUCKER

## AUGUST 2017

### ADVERTISERS INDEX

Advanced Hydraulic and Ind.  
Supply.....6  
Alpine Industrial LLC .....11  
Betts Truck Parts and  
Service.....5  
G.W. Gannon Equipment .....4  
General Trailer .....3  
H.D. Transaxle Inc. ....17

Harbor Saw & Supply.....15  
Knox-Douglas, Inc.....14  
L&M Truck Sales, Inc. ....12  
Lincoln Industrial Supply .....7  
LKQ K.C. Truck Parts.....19

LKQ Wholesale Truck Parts .9  
Miller Truck Salvage LLC....15  
Scheller Diesel Service.....18  
Schott Parts &  
Accessories.....10  
St. Johns Truck &  
Equipment .....8  
The Gear Box Inc.....4  
Tim Morgan Insurance .....14  
Washington Contract  
Loggers Assoc.....12

Washington Truck  
Rebuilders .....16  
Whit-Log, Inc.....13

#### WANTED

**Log Truck Drivers or  
Owner Operators  
Needed**

to haul logs in central  
Montana.

**Call 406-670-1874**  
(leave message)

#### FOR SALE



**2004 T800 Kenworth,  
Short Logger Package,**

#45, Cummins ISX CM 870, Jake  
brake, 18 spd, Single spd Eaton  
rear-ends (DSP-463P) 4:11 gears  
w/locker, Hendrickson Haul-Max  
walking beam suspension, 3/8 steel  
frame, 265" wheelbase, 4 axle truck,  
2 axle Whit-Log trailer, SI electronic  
scales .....**\$89,500**

**541-863-1501**

#### FILTERS

Air • Fuel • Water • Oil • Hydraulic

**Gates Hoses & Fittings  
Lincoln Lubrication Equip.**

Open Monday - Friday 7:30 am - 5:30 pm  
Saturdays 8 am - 1 pm

**Williams Oil Filter Service Co.  
WOFSCO, INC.**

1247 Puyallup Ave., Tacoma, WA 98421

(253) 627-8163

Toll Free: **1-800-522-1250**

#### FOR SALE



**1976 GMC Short Logger,**  
8V-71, 13 speed, Prentice 110  
loader **\$9500 OBO** Mulino, OR

**503-329-1546**

or **503-824-2605**



*What can we  
**BUILD**  
for you?*

**888-222-5201**



**(800) 622-5170 • (360) 736-3344**

# KC TRUCK PARTS

**183 STATE HWY. 508, NAPA VINE, WA.**  
**www.LKQheavytruck.com**



**2012 KW T800 Daycab,** Cummins ISX 15,  
RTLO18918B, 46K Rears on AG 400, .....  
..... **PARTING OUT**



**2009 PETE 389,** Cummins ISX15,  
RTLO18718B, Air Ride **PARTING OUT**



**2008 PETE 389,** Cat C-15, RTLO18918B,  
46K on Air Ride.....**PARTING OUT**



**2008 389 PETE,** Cummins ISX 15, 18  
speed Fuller, 40K Rears on Air Ride .....  
..... **PARTING OUT**



**2003 PETE 379,** Cat C-15 6NZ,  
RTLO18913A, 40K rears on Air .....  
..... **PARTING OUT**



**1999 IH Fuel Delivery Truck,** C-12 Cat, Fuller  
9 speed, air leaf, 4 compartment Clough alum.  
tank, with pup & 2 reels, has cab & hood  
damage.....**WILL BE SELLING COMPLETE**