

# LOG TRUCKER

VOLUME 44 NUMBER 12

To Advertise Call (800) 462-8283

DECEMBER 2017



*Merry Christmas from your friends at Log Trucker*





# FEATURED IN THIS MONTH'S ISSUE

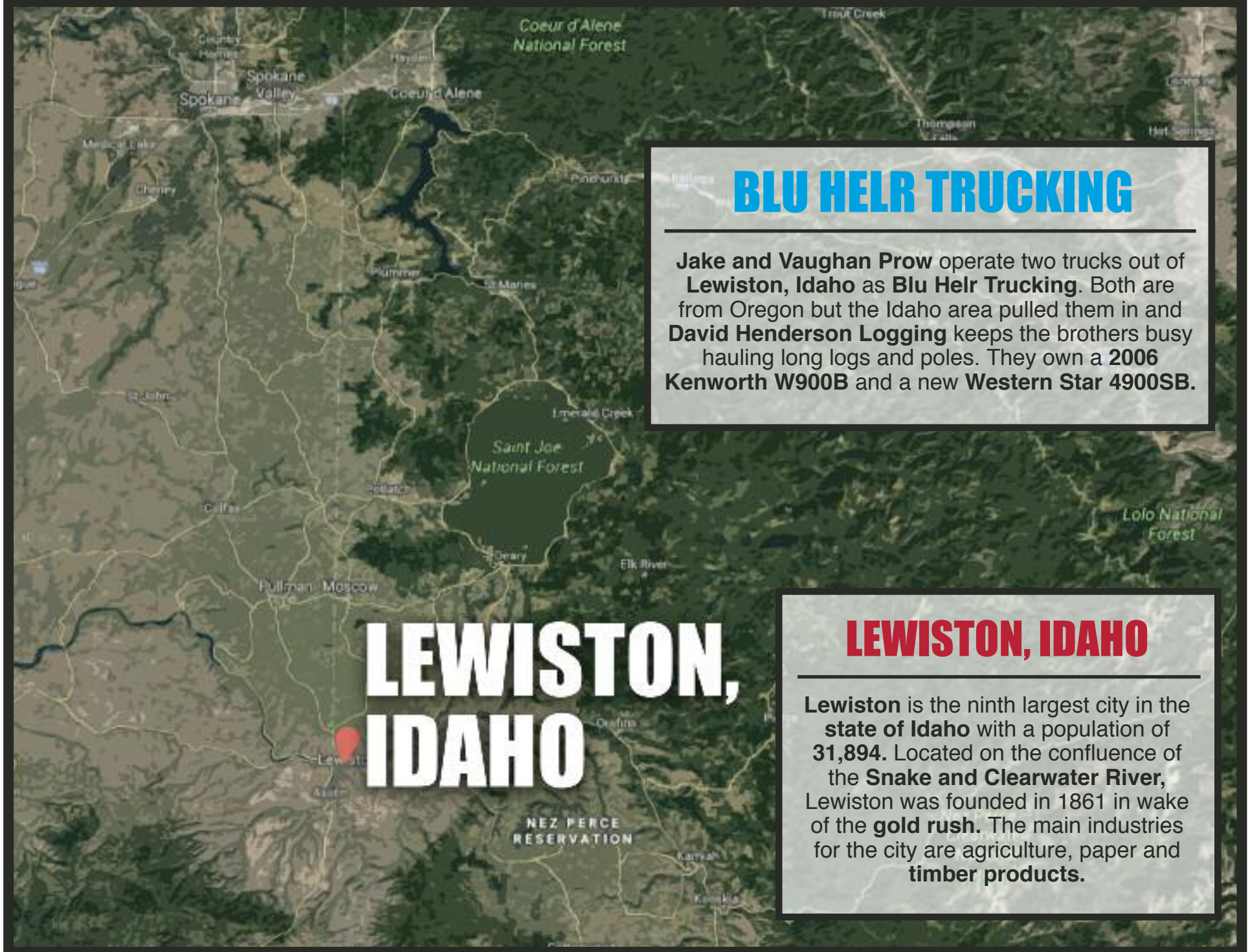

## BLU HELR TRUCKING

Jake and Vaughan Prow operate two trucks out of Lewiston, Idaho as **Blu Helr Trucking**. Both are from Oregon but the Idaho area pulled them in and **David Henderson Logging** keeps the brothers busy hauling long logs and poles. They own a **2006 Kenworth W900B** and a new **Western Star 4900SB**.

## LEWISTON, IDAHO

## LEWISTON, IDAHO

Lewiston is the ninth largest city in the state of Idaho with a population of 31,894. Located on the confluence of the **SNAKE and Clearwater River**, Lewiston was founded in 1861 in wake of the **gold rush**. The main industries for the city are agriculture, paper and timber products.

## IN THIS ISSUE



**ON THE FRONT:** Blu Helr Trucking's Western Star 4900SB is the background for Jake and Vaughan Prow. Ike, their trusty dog also wanted to be on the cover.  
See story starting on Page 4

### 4. HOME RUN HAULERS

**BLU HELR TRUCKING** by Brandon Hansen

### 17. TIME FOR TOYS

**LLOYD JOHNSON** by Brandon Hansen

### 15. TRUCKS OF THE LOGGERS PLAYDAY

**HOQUIAM, WA** by Aaron Kitahara

### 19. ADVERTISERS INDEX

WE'VE GOT WHAT YOU WANT

*Subscriptions make a great gift!*

**Buy a Subscription so you don't miss a single issue:**  
**[www.loggersworld.com](http://www.loggersworld.com)**

## LOG TRUCKER

Founded in 1975 by Finley Hays

Published by

**LOGGERS WORLD LLC**

Phone **(360) 262-3376**

PUBLISHERS.....Kevin & Nancy Core

EDITORS EMERITI.....Finley Hays, Mike Crouse

EDITOR/WRITER.....Brandon Hansen

ADVERTISING.....Kevin Core

OFFICE MANAGER.....Nancy Core

**POSTMASTER:** Send address changes to:

**LOGGERS WORLD LLC,**

P. O. Box 1631, Chehalis, WA 98532-8425

**E-Mail:** [logworld@aol.com](mailto:logworld@aol.com)

**SUBSCRIPTION RATE (In U.S.A.):**  
**\$25.00 per year; Two years for \$50.00**

LOGGERS WORLD LLC cannot and does not assume responsibility for the contents of any advertising in Loggers World. The representations made by advertising is the responsibility of the advertiser and not Loggers World. Loggers World does not knowingly accept advertising that is false or misleading. The limit of Loggers World liability in case of a mistake made in advertising copy by Loggers World will be the charge of the actual space containing the error or less for that particular advertisement





## Deck Your Truck with a GENERAL TRAILER

Best wishes for a Merry Christmas and  
thank you for placing your trust in us.

### ★ GENERAL TRAILER ★

*Building the Best...Repairing the Rest.*

Any piece of equipment, or Christmas present, should provide you with total satisfaction, which is what you'll experience with this used GENERAL 60-Ton Lowboy



Introducing  
the New  
GENERAL  
Composite  
Aluminum  
Cab Guard

Call for a Quote

Santa has his elves to protect him and now you can count on the protection of this GENERAL Composite Aluminum Cab Guard. Give the General a call at 1-800-452-9532 and we'll work with you to get a new cab guard under your tree!

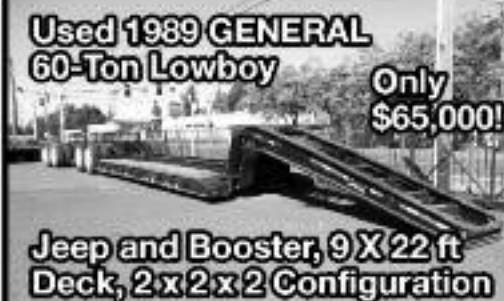

Used 1989 GENERAL  
60-Ton Lowboy

Only  
\$65,000!

Jeep and Booster, 9 X 22 ft  
Deck, 2x2x2 Configuration

Any piece of equipment, or Christmas present, should provide you with total satisfaction, which is what you'll experience with this used 60-Ton Lowboy from the GENERAL.

Thank you, Muddy Creek  
Transport of Sweet Home, OR

Purchased  
New Peerless  
53-ft Live Floor  
Trailer

To reduce their equipment worries and make their holiday brighter, Muddy Creek Transport out of Sweet Home, OR made the connection to a new Peerless 53-ft Live Floor Trailer from the GENERAL. Thanks, Adam Spencer!

Call the General's Headquarters.  
**1-800-452-9532**

Thank You, Hopkes Logging  
of Tillamook, OR



Purchased  
New GENERAL  
Lowboy Set.

Thank You, Freightliner NW  
of Coburg, OR



Purchased New  
GENERAL Long Logger

As happy as a kid on Christmas morning, That's how Freightliner NW of Coburg, OR feels with this robust GENERAL Long Logger that will provide years of service. Thanks, Freightliner NW!

Thank you Tyler Picknell  
and T-3 of Roseburg, OR



Purchased New GENERAL  
Crossgate Belly Dump

In order for Tyler Picknell and T-3 to stay in business as long as Santa, they need quality equipment they can count on, like this new GENERAL Crossgate Belly Dump. Thanks, Tyler!

New 2017 and 2018  
Peerless 53 Ft. 4-Axle  
Drop Center  
Chip Vans  
in Stock



New in Stock



Peerless Live  
Floor Trailers

Call  
Jerry  
for a  
Blowout  
Quote  
Today!

Call Jerry Blair in Oregon City **1-800-452-9683**



## DECEMBER PARTS SPECIALS

**PROTECH**  
MADE IN USA

Many other PROTECH products  
in stock. Call for price  
and availability.



64-6221  
Cross Body Tool Box Alum  
For 1999-2014 Ford Super Duty  
\$749.50 Ea



87-6830-24  
Mesh Cab Rack  
Fits most Pick Ups  
\$379.50 Ea

### Spray Guard

50140067-1 8" Flexible 14" Filament Under-Mount	\$45.75 Ea
55078073-2 6" Flexible 7" Filament Side-Mount	\$29.95 Ea
55078073-4 6" Flexible 7" Filament Under-Mount	\$29.95 Ea
55118073-0 6" Flexible 11" Filament Side-Mount	\$32.50 Ea
55118073-4 6" Flexible 11" Filament Under-Mount	\$32.50 Ea
5400-0643-1 Under Mount 4" Alum. Brkt	\$4.90 Ea
5460-0648-3 Side Mount 4" Alum. Brkt	\$7.40 Ea
5511-1049-2 4" Runner 11" Filament	\$11.70 Ea

Schlegel

12053 7-Way Socket Solid Pin	\$13.15 Ea
12053-01 7-Way Socket Split Pin	\$12.95 Ea
12022 7-Way Plug With Spring	\$11.45 Ea
1232 4-Way Socket	\$8.15 Ea
1233 4-Way Plug	\$5.10 Ea
1235 6-Way Socket	\$9.45 Ea
1236 6-Way Plug	\$6.65 Ea

**Pico**

2254G 25 Pack Red Crimp Solder Heat Seal Butt Conn	\$24.50 Pack
2284G 25 Pack Blue Crimp Solder Heat Seal Butt Conn	\$25.50 Pack
2274G 25 Pack Yellow Crimp Solder Heat Seal Butt Conn	\$30.50 Pack
0003-SW 40 PC. Red/Black waterproof Heat Shrink Kit	\$28.50 Kit
0003-SS 54 PC. Solder & Heat Seal Term. Kit	\$56.95 Kit
2254A 100 Pack Red Crimp Solder Heat Seal Butt Conn	\$92.50 Pack
2254A 100 Pack Blue Crimp Solder Heat Seal Butt Conn	\$95.95 Pack
2274A 100 Pack Yellow Crimp Solder Heat Seal Butt Conn	\$114.50 Pack

NOTE: NOT ALL ITEMS ARE IN STOCK AT ALL LOCATIONS. HOWEVER, WE WILL BE HAPPY TO TRANSFER INVENTORY TO THE BRANCH NEAREST YOU.

Visit [generaltrailerparts.com](http://generaltrailerparts.com)

### SPRINGFIELD

1420 South B Street  
Springfield, OR 97477  
Phone: (541) 746-8218  
1 (800) 452-9532  
Fax: (541) 726-4707

### MILTON

7200 Pacific Highway East  
Milton, WA 98354  
Phone: (253) 926-8903  
1 (800) 562-8380  
Fax: (253) 926-8908

### OREGON CITY

21195 S. Highway 99 E.  
Oregon City, OR 97045  
Phone: (503) 263-2702  
1 (800) 452-9683  
Fax: (503) 266-9498

### REDDING

5875 Eastside Road  
Redding, CA 96001  
Phone: (530) 246-3813  
1 (800) 475-1057  
Fax: (530) 246-3823



**BROTHERS**

Blu Helr Trucking's Jake and Vaughan Prow pose in front of their 2006 Kenworth W900B.

# HOME RUN HAULERS

*Jake and Vaughan Prow stay busy in the woods of Idaho with family-owned Blu Helr Trucking*

**Photos by Kevin Core**  
**Story by Brandon Hansen**  
*For Log Trucker*

Baseball seems like an unlikely path to the logging industry, but for collegiate baseball athletes Jake and Vaughan Prow, it showed them work they wanted to get into.

Now baseball and loggers/log truckers are nothing new. Plenty of loggers have traded the corked boots for cleats (or just left them on) for some extra curricular sporting events. Baseball, after all, was a pastime in many logging towns and logging

camp.

But for the Prows, baseball was a gateway to the timber industry.

While the two were playing baseball as kids - something that would eventually lead them to playing at LC State in Lewiston and Walla Walla CC - Jake got to know Spud Jr. Smith, whose family was heavily involved in the timber industry.

That sparked an interest for Jake that has now resulted in the two beginning a

(Continued on Page 8)  
**See "Blu Helr"**



## GEAR BOX Inc.

TRANSMISSION & DIFFERENTIAL REBUILD & REPAIR

1037 State Street (Exit 79 off I-5) • Chehalis, WA.

8:00 a.m. - 5:00 p.m.  
 Monday - Friday

**(360) 748-8350**

**Let us Lower Your Cost Per Mile  
 with our  
 High Quality Time & Material Rebuilds**

★ FULLER  
 ★ EATON  
 TRANSMISSIONS  
 TRANSFER CASES  
 ★ SPICER  
 ★ ROCKWELL  
 DIFFERENTIALS  
 AUXILIARIES

Complete Time &  
 Material Rebuild  
 Unit Comes with a  
 1 Yr. Unlimited  
 Mileage Warranty



*We Pride Ourselves on Genuine OEM Parts*

**CUSTOM BUILD or EXCHANGE**





### BLU HELR TRUCKING IN ACTION

LEFT: Driver Vaughan Prow stands next to Madill loader operator Gary Hardy. Gary operates the Madill 2850C for owner David Henderson.

ABOVE: Blue Helr's 2006 Kenworth W900B has a nice load heading to the mill back when there wasn't snow on the ground.

**855-968-7875** (toll-free) • 208-743-2547 (local)

Bill Bartz • Cell: 208-790-2084 • email: [bbartz@idahotrucksales.com](mailto:bbartz@idahotrucksales.com)

Kurt Ausman • 208-791-5878 • email: [KurtAusman@gmail.com](mailto:KurtAusman@gmail.com)

2934 North & South Hwy, LEWISTON, ID 83501 • Parts open 6:00AM to 6:00PM weekdays. 8:00AM - 12:00PM Saturdays



**2018 VetStar Military Appreciation Finance Program. \$2,000 down payment match on all new Western Star Models** (Glider Kits or used, not eligible). Minimum amount to finance, \$80,000, Minimum term; 36 months. Ask for details!

**(2) New 2019 Western Star 4900SF** – Detroit DD16 engine, 600HP @ 1850 Torque; RTLO-18918B transmission; 14,700 # steer axle; 46,000 # Meritor rears, 3.73 Ratio with double lockers; 46,000 # Hendrickson Haulmaax suspension; (one with 245" & one with 250") wheel base.

**POR Coming Soon!**

**2014 Western Star 4900SB Glider Kit** – Detroit S60 engine; 550HP @ 1850 torque; RTLO 18918B Transmission. 14,600 # steer axle; 13,200 # steerable pusher; 46,000 # Meritor RT-46-160, 3.90 Ratio with double lockers. 46,000 #air ride

suspension, 270" Wheel Base. **POR Coming Soon!**

**2014 Western Star 4900SF** – Cummins ISX engine; 550 HP @1850 torque; RTLO-18918B transmission, 14,700 # steer axle; 13,200 # steerable pusher axle; 46,000 # Meritor rears with double lockers; 46,000 # Airliner suspension; 270" Wheel Base.

**POR Coming Soon!**

**For a Limited Time:**

**2018 Western Star Association Rebate.** For members of the American Loggers Council & its affiliates (ALC members) \$5,000 rebate (4900 models only) that can be used in lieu of down payment, cash back or towards parts & Service. Ask for details!

**2007 Kenworth W900L Log Truck** – Cat C15 Acert engine with 550HP (some blow by); RTLO-18918B transmission; 13,200 # front axle; 46,000 # rears with 4.10 ratio & double lockers; 13,200 # steerable drop axle. 268" wheel base with 120" after frame. 1989 Peerless long log trailer & Truck equipment.

**POR**

**2006 Western Star Log Truck** – Cat C15 Acert engine 550 HP @ 1850 torque; RTLO-18918B Transmission; 14,700 front axle; 13,200 steerable pusher axle; 46,000 Meritor RT-46-160, 3.91 Ratio with double lockers. 46,000 # Hendrickson HN462 Suspension. Dual St Stl air cleaners, St Stl Sun visor. 1987 Fruehauf long log trailer & Equipment. 8 ½ solid bunks, 2 stage reach; Vulcan 340 Scales. **POR**

**1996 Mack CH613 Cab and Chassis** – E 7 Mack engine 427HP; 18 Speed transmission; 14,300 # front axle; 40,000 # rears with 4.17 ratio. 254" wheel base. **POR**



**Serious trucks.™**

[www.idahotrucksales.com](http://www.idahotrucksales.com)



**Idaho TRUCK SALES**







### EMPTY NOW

Blu Helr Trucking's Western Star 4900SB with Whit-Log gear gets unloaded at the log yard. Recently Blu Helr Trucking sold the 1995 Kenworth and upgraded to a new Western Star 4900SB through Idaho Truck Sales in Lewiston and Bill Bartz. "I looked at a couple Western Stars and asked a couple of guys who run them and they said they loved them," Jake said. "We decided to make the move and it's been a good buy. It has a good motor and fuel economy. I'm still a Kenworth fan, but this move was good for business."

## Advanced Hydraulic Supply

4444 N.E. 148TH Avenue, Portland OR, 97230

**1-877-887-1730 • (503) 289-0354**

# NEED PARTS?



**AIR BRAKE (NTA)  
QUICK FIX**  
Includes Over 30 Pieces



**NTA PUSH to  
CONNECT  
FITTINGS**  
Over 20 Pieces

**SCHOTT**  
PARTS & ACCESSORIES

**503-463-0500**

CALL FOR OUR CATALOG!

**I-5 Exit 263**

8983 TRUCKMAN WAY  
SALEM, OR 97303

SHOWROOM HOURS  
Monday-Friday: 8:00-5:30

**WWW.TRUCKCHROME.COM**

## Merry Christmas!

Chrome Spring *Sale Price*  
Logger Hangers **\$89.95/ Pair**



**GIFT  
CERTIFICATES  
AVAILABLE**

**Great Gifts For Your Trucker!**

### Christmas Coupon

**10% OFF**

Wheel & Flap Chrome,  
Bumpers.  
Some items excluded.  
Please Call.  
Good Thru 12/31/17

Mention this ad or bring  
in coupon for discount

### CHROME BUMPERS

We Have *Square & Tapered* Bumpers,  
12", 16", 18", 20" & 22"  
SPECIAL CUT OUTS - No Problem!

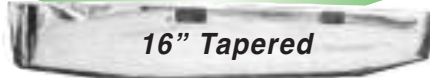

**16" Tapered**





## EVERYTHING HOOKED UP?

Blu Helr's Vaughan Prow makes sure everything gets hooked up on the company's Western Star 4900SB before the logs get there.

Check out our 2017  
line of dump boxes  
Call for a quote today!



We manufacture & service  
Lincoln Log Trailers  
Parts & Service Shop  
available for most brands



Monday – Friday 7:30 – 4:30  
Saturday 8:00 – 2:00  
4130 Tumwater Truck Route,  
Port Angeles 98363  
1-800-492-6122 / 1-360-457-6122  
[www.lincolnindustrialcorp.com](http://www.lincolnindustrialcorp.com)

You Tube Like us on Facebook



We offer welding services and  
general welding supplies,  
plasma cutting,  
stock steel, and propane



Auburn  
Office  
Wayne Kinberg  
1-888-212-0514  
1-360-461-3795



Flat Beds,  
Tilt Beds,  
Hooklifts,  
Truss and  
Tilt Trailers





(Continued from Page 4)

trucking company based in Lewiston, Idaho called Blu Helr Trucking.

Originally from Madras, Oregon, Jake and Vaughan didn't grow up in a timber industry-involved family. When Jake met Spud Jr., they began riding along with Spud's grandpa Rodney and father Spud.

"I really liked being in the log truck and seeing how the logging industry works," Jake said. "It was an interesting job, it wasn't the same everyday and everybody worked hard for what they got. Obviously, I like it because I've been doing it for 13 years now and there's never been a dull moment"

Jake and Vaughan eventually ended up playing baseball at Lewis and Clark State College and after a year Jake transferred to Walla Walla CC. That showed them the timber industry in Idaho and after school, Jake went into the workforce driving truck for Rodney Smith for about three years where he learned the ways of the trade.

At age 20, Jake began a log truck company with his father Pat in 2007. His first truck was a 1986 Kenworth W900B.

"I always wanted to be my own boss and the time I spent with Rodney really showed me a lot about the industry and how things work," Jake said.

Eventually Vaughan, who is the older brother by two years, took Pat's spot in the company. Pat went on to North Dakota because of the oil boom. By this time, Lewiston had grown on the brothers so the whole family decided to move from Oregon out to the city.

"It's always fun to work with family and you might have your disagreements

but it's always good working with my brother," Jake said.

In 2012, the company bought a 1994 Peterbilt and one year later, they upgraded the 900B to a 1995 Kenworth W900B. Then in 2014, they sold the Peterbilt and upgraded to a 2006 Kenworth W900B.

They hauled for several loggers around the area, including Bob Danielson in St.

Maries. While in Lewiston they found David Henderson Logging and began hauling for him as the output and work was definitely there for the brothers.

"David keeps us busy and he's a great contractor to work for," Jake said.

Henderson calls Jake and Vaughan to dispatch them on his jobsites, and when Idaho goes through its spring

breakup of muddy roads, the brothers head to the coast to haul for Evenson Logging and Jon Greenup Logging.

Recently Blu Helr Trucking sold the 1995 Kenworth and upgraded to a new Western Star 4900SB through Idaho Truck in Lewiston and Bill Bartz.

"I looked at a couple West-

(Continued on Page 14)

See "Blu Helr"

# ST. JOHNS

## THE POWERTRAIN PEOPLE

# TRUCK & EQUIPMENT



**REBUILT TRANSMISSIONS/ REAR ENDS**  
(ALL SOLD EXCHANGE)



**FREE FREIGHT!**

St. Johns will pay the Freight to you on any REBUILT TRANSMISSION or REAR END sold in Washington, Oregon, or Idaho

### DIFFERENTIALS - ROCKWELL

PRICES VARY BY RATIO, ALL PRICES STARTING AS LOW AS...

RD20-145	\$2,140.00
RR20-145	1,240.00
RDL20-145	2,615.00
RRL20-145	1,765.00
RD23-160	3,165.00
RR23-160	1,865.00
RDL23-160	3,715.00
RRL23-160	2,440.00
SQHD	1,965.00
SQHR	1,610.00
QD100	1,750.00
QR100	1,190.00
SSHHD	2,215.00
SSHHR	1,390.00

### EATON:

DT461P	\$4,650.00
RT461	3,050.00
DD461P	4,915.00
RD461	2,800.00
DS461P	3,425.00
RS461	1,800.00
DS402	1,800.00
RS402	1,175.00
DS404	1,700.00
RS404	1,150.00
DT402	2,875.00
RT402	1,950.00
DD404	2,825.00
RD404	2,050.00
DSH40	2,300.00
RSH40	1,575.00
DDH40	3,550.00
RDH40	2,200.00

Many Other Transmissions And Differentials Available... Call Us First!  
Custom Repair For Your Unit  
**CALL US FIRST!**

### CUMMINS® MANIFOLDS

3801322 855 LARGE PORT	\$325.00
3801915 855 SMALL PORT	295.00

### FLYWHEEL HOUSINGS

CUMMINS® FW HOUSINGS	CAT® FW HOUSINGS
3680063 ISX	\$795.00
3036005 855/N14	399.00
1302802 3406E	\$1295.00
1694153 C15	1795.00

### REPLACEMENT FLYWHEELS



CUMMINS FLYWHEELS	CAT FLYWHEELS
3071535 855/N14	\$435.00
3016495 855	375.00
9L6392 3208	\$425.00
9Y9313 3208	399.00
4P4797 3406	465.00
DETROIT FLYWHEELS	
23509709 SERIES60	\$450.00

### FULLER

RT/RT06613	\$3,075.00
RT8609A	3,150.00
RT012513	2,550.00
RT012515	2,350.00
RTX12609B	2,325.00
RTX14609B	2,400.00
RT014613	2,625.00
RTLO14613BP	3,350.00
RTX14708LL	2,600.00
RTX14710B/C	2,700.00
RTX14710B/CP	2,900.00
RT14715	3,200.00
RT015613P	3,000.00
RTX15710B/CP	2,900.00
RT0/RTX15715P	3,300.00
RTX16710B/CP	2,900.00
RTAO16710B/C	4,000.00
FRO16210B/C	3,395.00
RTLO16610BP	2,925.00
RTLO16618A	3,550.00
RTLO14713A	3,125.00
RTLO16713A	3,600.00
RTLO16718B	3,900.00
RTLO16913A	3,600.00
RTLO16918B	4,150.00
RTLO18718B	4,150.00
RTLO18913A	3,895.00
RTLO18918B	4,395.00
RTLO20913A	4,675.00
RTLO20918B	4,875.00
RTLO22918B	6,550.00

### ROCKWELL

RMX10-145A	\$3,465.00
RMX10-165A/C	3,415.00
MO16G10C	3,915.00

### POWERSTEERING PUMPS / GEARS

#### PUMPS

- Eaton
- Parker
- Vicker
- Saginaw
- ZF
- TRW

#### GEARS

- Ross/TRW
- Saginaw
- Bendix
- Gemmer
- Sheppard



Same Day Shipping!

## EATON/FULLER TRANSMISSIONS



Eaton/Fuller Transmissions now come with a TWO YEAR UNLIMITED MILEAGE WARRANTY.

- All Eaton/Fuller Transmissions are dyno tested.
- Our Fuller Transmissions are remanufactured using genuine OEM overhaul kits, gearing, synchronizers and air systems. We are one of the few rebuilders in the nation using all OEM parts in our Fuller transmissions.

## Fuller 18 speeds



Built with 100% NEW OEM gearing  
RTLO18918B ...\$6895.00 exchange  
RTLO20918B .....7295.00 exchange  
RTLO22918B .....7695.00 exchange

Call for outright pricing and exchange details

**FULL SERVICE TRUCK & TRAILER REPAIR**  
**Call St. Johns First!**

8435 N. CRAWFORD STREET • PORTLAND, OREGON 97203

NATIONWIDE TOLL FREE:  
**(800) 222-8435**

PORTLAND:  
**(503) 286-8336**

FAX:  
**(503) 283-3423**



## REMOVING WRAPPERS

Blu Helr's Western Star 4900S has its wrappers removed by Vaughan Prow at the Idaho Forest Group log yard in Grangeville.



Pickup  
in Oregon

**NO SALES TAX!**

**We Do  
Limited Installs  
Like for Like**



**CAT  
C-15  
6NZ**

Several  
Single  
Turbos,  
Super  
Conditon

Low Miles, **CALL!**

**We Buy**

**Running, Wrecked,  
End of Life Trucks,  
and Stand Alone  
Parts, Too!**

**DETROIT SERIES "60"**



Dedec III, IV & V Engines Available,  
With Jakes, Good Condition



We are your  
**NORTHWEST HEADQUARTERS**  
for 46,000-lb. **ROCKWELL MERITOR &  
EATON TANDEM REARENDS**  
all ratios, all suspensions, rebuilt gearheads  
& parts available - **CALL NOW!**



### REBUILT TRANSMISSIONS

RTO-14713 . . . . \$3,100	RTO-16915 . . . . \$2,650
RTO-16713 . . . . \$3,300	RTLO-16618 . . . \$3,200
RTO-16913 . . . . \$3,500	RTLO-16718 . . . \$3,850
RTO-18913 . . . . \$3,750	RTLO-18918 . . . \$4,350
RTO-14715 . . . . \$2,750	RTLO-20918 . . . \$4,625



# WHOLESALE TRUCK PARTS & EQUIP.

Nationwide & Canada

**1-800-547-1315**

5925 N.E. Portland Highway, Portland, OR 97218

HOURS: 8:00 - 5:00 Monday thru Friday

FAX# 1-503-288-6337 • DELIVERY AVAILABLE

**503-288-6333**



## IN THE SNOW

Blue Helr's 2006 Kenworth W900B, driven by Jake Prow, looks nice in the snowy landscape of the base of the Idaho panhandle near Lewiston.

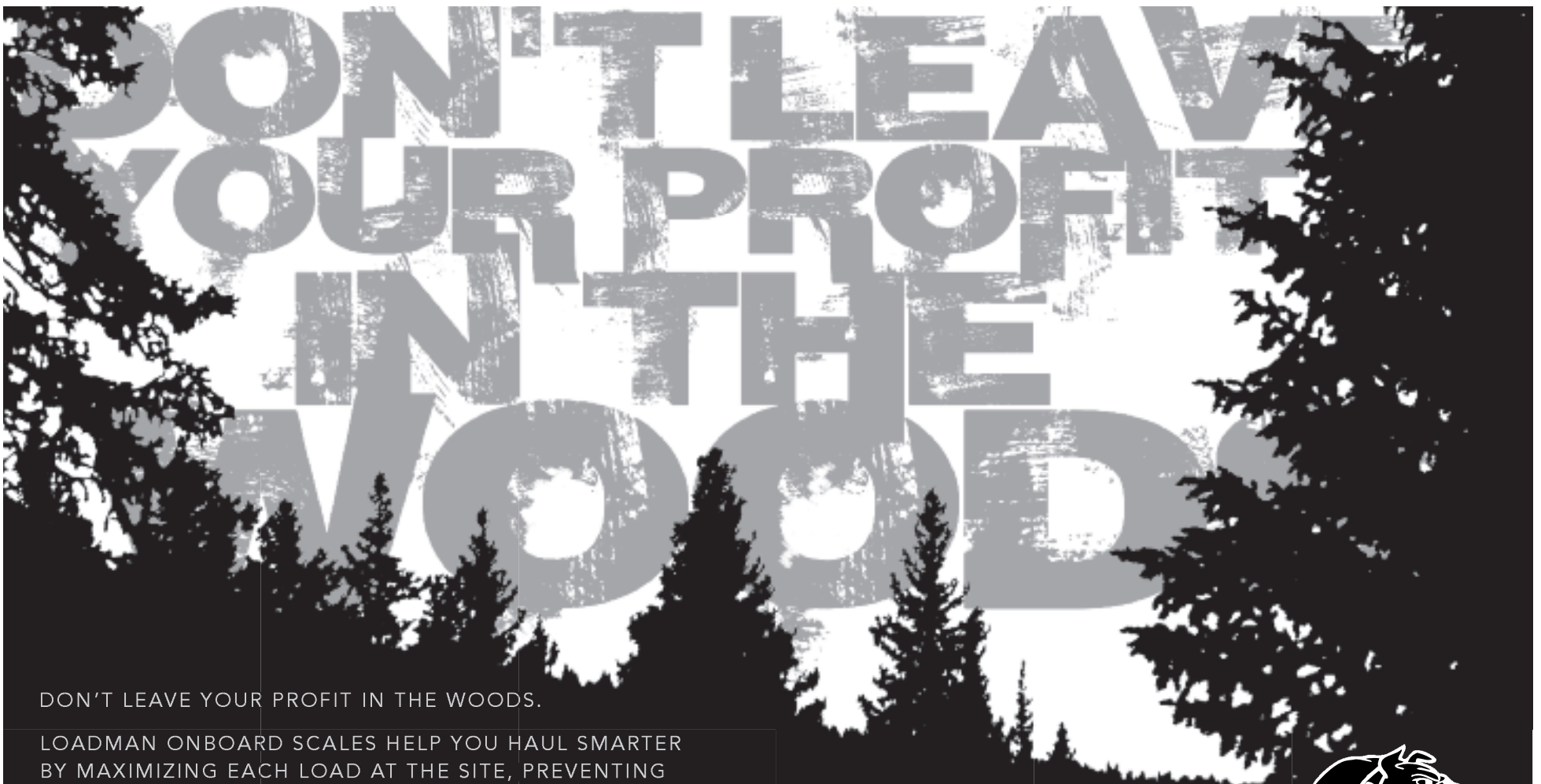

DON'T LEAVE YOUR PROFIT IN THE WOODS.

LOADMAN ONBOARD SCALES HELP YOU HAUL SMARTER BY MAXIMIZING EACH LOAD AT THE SITE, PREVENTING INEFFICIENT TRIPS CAUSED BY UNDERLOADING.

CONFIDENT YOU ARE HAULING A FULL LOAD THAT IS SAFE AND LEGAL EVERYTIME ALLOWS YOU TO BE IN CONTROL OF YOUR TIME AND EXPENSES.

LEARN MORE: CALL 1.888.562.3626 OR VISIT [WWW.LOADMEN.COM](http://WWW.LOADMEN.COM)





**GETTING READY**

Standing on his trailer, Vaughan Prow puts on the extensions to get ready to receive a fresh load of logs.



Bruce, Todd, Aaron & Christine  
wish you all

# Happy Holidays

*and  
a Prosperous  
New Year!*



## CALL (208) 877-1714



ALPINE INDUSTRIAL, LLC

2810 Big Bear Ridge Road  
P.O. Box 341  
Deary, ID 83823

Phone: 208-877-1714

Fax: 208-877-1198

EMAIL:

[alpineindustrial@moscow.com](mailto:alpineindustrial@moscow.com)



**Let us  
build you a  
BRAND NEW  
ALPINE  
Trailer**

or call us for an  
appointment to  
service your existing  
trailer





### GETTING READY

Vaughan Prow unhooks the Whit-Log Trailer from the Western Star 4900SB for another trip into the woods.

## LOG TRUCKER VIDEO

Use your smart-phone to download a QR code reading app and scan this code to see video of Blu Helr Trucking in action around Lewiston, Idaho.



**LOG AND PULP LOADERS**

**Several Used Sercos Available**

**NEW SERCO 160PH POLE HANDLING PACKAGE IN STOCK**, lifts up to 110' poles

**2007 PETERBILT 335**, ISC Cummins, Fuller 10 speed, 33,000 GVW, 14' service body, IMT 6025 Service Crane, 10,500# capacity, hyd air compressor STK. #5472

**2006 STERLING ACTERRA**, Mercedes diesel, 6 speed, 33,000 GVW, 11' service body, IMT 5525 Service Crane, picks 1840# @ 25'4", radio remotes, hyd air compressor STK. #5473

**2009 INTERNATIONAL 7400**, DT466, Jake, 8LL 10 speed, 16,000# front, 40,000# rear, 4000 Gallon Valew Water Tank, 2 front, 1 side, 2 rear sprays, hose reel STK. #5464

**NEW SERCO 160PH LOG LOADER**, 25' reach, 400° rotation, 46" continuous rotating grapple, 18,826# capacity, 10° off set jib STK. #5329

*Sold & Serviced by*



**L&M Truck Sales, Inc.**  
**4001 E. Boone Ave.**  
**Spokane, WA 99202**  
**800-796-9813**



**Call (800) 422-0074 or join  
 online at [www.loggers.com](http://www.loggers.com)**

### Membership Highlights...

- Master Logger Program (exceeds SFI logger training requirements)
- Monthly Springboard Magazine
- First aid/cpr and pilot car training
- Log A Load For Kids® - giving campaign for Children's Hospitals
- WCLA Insurance Agency - top coverage for the timber industry
- Employee benefits programs through WCLA's benefits partner: Kibble & Prentice
- WCLA Claims Management Program - providing the benefit of savings on L & I premium costs, improved safety standards and reduced claims costs



**VAUGHAN PROW**

Vaughan Prow is pictured here driving Blu Helr's Western Star 4900S. He played baseball for two years at LC State, and got interested in log trucking after brother Jake began Blu Helr Trucking.



# WHIT-LOG Trailers

**P.O. BOX 668 • WILBUR, OR 97494**

**WE ARE NOW ON FACEBOOK!**  
Check out all the pictures and  
Like Our Page!



[www.facebook.com/Whitlogtrailers.com](http://www.facebook.com/Whitlogtrailers.com)



**Hopkes Logging, TILLAMOOK, OR,** Brand New 2017 Whit-Log SEWC100 Long Logger with Matching Truck Equipment. Custom Steel Cab Rack, Double Tapered Stinger, All Stainless Light Bars, and Much More... **Thanks Adam!!**



**Hopkes Logging, TILLAMOOK, OR,** Brand New 2017 Whit-Log SEWC100 Long Logger with Matching Truck Equipment. Custom Steel Cab Rack, Double Tapered Stinger, All Stainless Light Bars, and Much More... **Thanks Adam!!**



**Erickson Logging Inc., GIG HARBOR, WA,** Brand New 2017 Whit-Log SPE300 Three Axle Stick Trailer with Matching Truck Equipment. Custom Aluminum Cab Rack, Custom Tire Rides, and Much More... **Thanks Kurt!!**

*Happy Holidays*  
from your friends  
at Whit-Log!



**Randy Remington Trucking, TILLAMOOK, OR,** Brand New 2017 SEWC100 Long Logger with Matching Truck Equipment. Custom Steel Cab Rack, Double Tapered Stinger, Stainless Accessories, and Much More... **Thanks Randy!!**

**OFFICE: (541) 673-1166**  
**EMAIL: [brett@whitlogtrailers.com](mailto:brett@whitlogtrailers.com)**

**TOLL FREE 1-800-452-1234**  
**[www.whitlogtrailers.com](http://www.whitlogtrailers.com)**



(Continued from Page 8)

ern Stars and asked a couple of guys who run them and they said they loved them," Jake said. "We decided to make the move and it's been a good buy. It has a good motor and fuel economy. I'm still a Kenworth fan, but this move was good for business."

With Henderson picking up some pole contracts, Blue Heeler has been using their Whitlog and General Trailers to haul some 95-foot poles along with long logs.

"It's a bit interesting when you have 45-feet sticking out the back," Jake said.

They've been running poles to Grangeville and to St. Maries in Idaho and Jake said they've been doing a number of hauls into Oregon as well. They operate in Idaho for about 8-9 months and then do West Coast hauls when the spring breakup hit.

During the summertime, Jake also fights fires, while they also offer lowboy services.

When it comes to maintenance, Matt and Jason Rayner do the work for the brothers in their shop and has done so since Blu Helr Trucking began. Wayne Gallagher's welding business has also helped the company out a lot.

"He's gotten us out of a lot of pinches," Jake said. "When we need a welder, he helps us out in a huge way."

Bill Lowry Trucking out of Princeton has also helped out Blu Helr quite a bit.

When it comes to log trucks, they hope to keep re-



### BROTHERS PROW

Baseball seems like an unlikely path to the logging industry, but for collegiate baseball athletes Jake and Vaughan Prow, it showed them work they wanted to get into. Jake's best friend Spud Smith Jr. got him interested in the timber industry and after getting out of college, Jake got into log trucking and eventually got his brother Vaughan into it.

volving trucks to keep newer machines on the road.

"We try to keep a 4-5 year plan, but we also want to see how the timber industry works out," Jake said. "We don't know what the future holds. We believe what works in a good economy works in a bad economy. That's why we believe in a four-to-five year turnaround."

Vaughan and his fiancee does the billing from the company and Georgina in Oregon does the permits for the company as well.

"We kind of try and do as much stuff as we can ourselves to stay ahead of things," Jake said.

Thanks to baseball and welcoming timber families, two more brothers have entered the log trucking industry. While it may not be typi-

cal, Blu Helr Trucking has found their way on the road and continue to keep logs moving.



KNOX

DOUGLAS, INC.

### NEW Silent Drive Ultra Flex Series UF-1013-1B

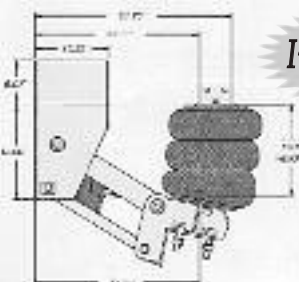

In Stock Now!

Pushers or Tag,  
Utilizes Steer  
Axle (Single  
Tire only)  
13,200 lbs  
Capacity

With Rebuilt Axle or your Axle.  
Call for your Application

Suspension and Air Parts in  
Stock and Available Now!



Authorized PULLTARPS Dealer.  
We carry parts and provide service  
for all your PULLTARPS needs

## SILENT DRIVE

Suspension  
Component  
Group

## Pederson

FOR LOGGING OR DUMP TRUCKS



### FENDER KITS

Spindle Mounted for Self Steering  
Auxiliary Axles. Available with  
instructions to install it yourself  
or we can do it for you.

**WE SELL and  
INSTALL THEM!  
CALL US!**

Need a "Brake" on your Truck Insurance Rates?

**T.W. MORGAN INSURANCE SERVICES**

Since 1991 Insurance & Financial Services Brokerage Agency

"AN AGENT WHO UNDERSTANDS TRUCKING"

- Log Trucks • DOT Fuel Bonds
- Dump Trucks • Chip Trucks
- Tow Trucks • Sand & Gravel Trucks
- Truckers General Liability & Cargo Available
- Short & Long Haul Trucking • 50-500 miles to unlimited mile radius

**90% of Our Quotes  
Save Our Callers \$\$\$  
WHAT ABOUT YOU?**

Ask for Tim • 503-245-3345 or 888-821-4717 • Tigard, Oregon  
Serving Oregon, Washington & California

We Accept



P.O. Box 5701  
Salem, OR 97304

503-363-0892  
fax 503-362-5435



15

# Trucks of the Hoquiam Loggers Playday Parade

## INTRODUCING...

### Aaron Kitahara - Roving Photographer

Aaron introduced himself to us as “a guy who likes to take pictures of trucks” and we like his work. Look for more of Aaron’s pictures in the coming months as he shares pictures of events we can’t make in person.



Photos by Aaron Kitahara



**MILLER TRUCK SALVAGE L.L.C.**  
**DIESEL TRUCKS & PARTS**  
15015 N. W. MILL RD. • PORTLAND, OR 97231  
“Specializing in '70's thru 90's”  
**(503) 283-1797**



1995 T800, N14, 10-spd Fuller, Rockwells on AG 100 **Parting Out**



1997 CH600, E-7, 10-spd Spicer, Spicer rears **Parting Out**

1981 W900A, BC3400, 13 spd Fuller **Parting Out**



2005 VNL Volvo, 18 spd Fuller, 46k Rockwell dbl lock **Parting Out**



1993 Volvo, low mile 3406C Cat, 13 spd Fuller, 402 Eatons, **Parting Out**



2005 KW T600, C15 Cat, Fuller trans, 404 on AG400 **Parting Out**



### ENGINES / TRANSMISSIONS Check With Us Before You Buy!

TRANSMISSIONS	ENGINES
• RT 6613 .....\$1,250	• 3406B 425 h.p. Inspected.....\$5,000 (Uninspected)
• RT 6610 .....\$1,250	• 8.3 Cummins, mech. \$3500 exchange
• RTO 15613 .....\$2,000	• 5.9 Cummins, runs good .....\$2,750
• RTO 14715 .....\$1,500	• Cummins BC 1-4 series.....3000-4500 exchange
• RTO 14613 .....\$1,500	• E-7 300 W/Jakes, good runner .....\$4000
• RTLO 16713A .....\$2,600	• 675 285 hp., low miles .....\$3500
• RTLO 18718B .....\$2,750	• 3406E 5EK- 2WS. 4000-6000 exchange
	• DDEC4 450hp., runs good.....\$5000

EXCHANGE REQUIRED ON SOME EQUIPMENT - CALL FOR SPECIFIC UNITS

Stop by and ask for the  
"LOGGER'S SPECIAL"  
for this  
**TRAEGER  
JUNIOR  
PRO**  
pellet grill



We have Stihl & Husqvarna chainsaws,  
a full wire rope & rigging shop,  
work clothes, calk boots, and much more.

**HARBOR**  
**Saw & Supply** inc.

3102 Simpson Ave. in Hoquiam!  
**800-786-6463 • (360) 532 4600**



# Trucks of the Hoquiam Loggers Playday Parade



*Photos by  
Aaron Kitahara*



## LOGGER'S SUSPENDERS FROM LOGGERS WORLD

- Heavy Duty 2" Straps
- Leather Straps or Heavy Duty Metal Clips
- Traditional Red with black Loggers World lettering



**PLEASE MARK YOUR PREFERENCE & SIZE...**

- ☐ **LEATHER ENDS**
- ☐ 46"
- ☐ 50"
- ☐ 54"
- ☐ **METAL CLIPS**
- ☐ 46"
- ☐ 50"
- ☐ 54"

**\$18.50**

Pair (U.S. Funds)  
WA residents pay  
\$20 including  
Sales Tax  
Plus \$7.50 Ship-  
ping (per pair)  
(Inside USA)

**BUTTONS \$3.00**  
for Leather Straps Pkg.

Send your order to:

**LOGGERS WORLD SUSPENDERS**  
P.O. Box 1631, Chehalis, WA 98532





# TIME FOR TOYS

*Christmas time means Idaho's Lloyd Johnson is busy making his wooden trucks - no word yet if he's picked up a contract with Santa*

**Story by Brandon Hansen**  
*For Loggers World*

While it's not Santa's Workshop, it certainly looks like it. Princeton, Idaho's Lloyd Johnson is a busy guy making wooden log trucks and self loader log trucks in his home woodshop.

Featured in April's edition of Log Trucker, Lloyd has been doing this type of work for 17 years and could be the go-to guy if you're looking for a Christmas gift for someone in the timber industry.

Lloyd has many several different scales and sizes of Kenworth and Peter-

bilt trucks. A regular log truck is just \$40 while his heavily detailed trucks can go up for \$170.

Johnson does custom work and if you send him a photo of the front, back and sides of the truck with good lighting and no shadows - he can make a reproduction of your very truck.

Johnson was born deaf and grew up in Gooding, Idaho and then went to the Idaho State School for the Deaf and Blind from 1976 to 1982 where wood shop teacher Harry Reed fostered Johnson's interest in woodworking.

He began selling trucks in 2000 and

now travels many to many shows during the year selling his trucks.

If you'd like to have one of Lloyd's trucks, make sure you order soon as he would have to have it to the UPS man by Dec. 15 to make it to your doorstep by Dec. 23.

Johnson added that if you're feeling like driving he does offer pick ups at his house.

To reach Lloyd, you can find him on Facebook under "Lloyd Johnson" or on MSN. Text him at 208-301-1665 or email him at [lloyd@potlatch.com](mailto:lloyd@potlatch.com). He also has a hotmail at [kenworth\\_lloyd@hotmail.com](mailto:kenworth_lloyd@hotmail.com).



**A-1 Truck Repair LLC**

550 COLUMBIA STREET • WOODLAND, WA.

**(360) 225-6327**

More Information available at [www.a-1truckrepairllc.com](http://www.a-1truckrepairllc.com)



Box installation on one of 5 new Peterbilt Chassis for Dietrich Trucking out of Vancouver, Washington. Thank you Richard and Jeff!



**WESTERN PETERBILT**

112 N. 1st Street, Cosmopolis, WA  
98537

Call for a quote today!  
(360) 533-8990

2018 Peterbilt 389



Cummins X15 565 hp,  
18-speed, Air Trac, 5-Axle  
Truck, Drum Brakes

2018 Peterbilt 367



Cummins X15 565 hp,  
18-speed, Air Trac, 4-Axle  
Truck, Disk Brakes, 2017 Whit  
Log Trailer



# BLAST FROM THE PAST

BY QUINN J. MURK FOR LOGGERS WORLD



## SMALL MILLS

A lot of small mills were quite haphazard affairs, quickly thrown together to cut out a patch of timber and then move on. But not all were like that, as this old photo shows. This mill was somebody's pride and joy. Look how clean everything is, nothing is scattered around. Also, the logs are brought in on a scoot. Placed directly on a roll-way, they arrived from the stump clean and ready for the saw. A small mill like this was really not too common.

## KENWORTH T800 4-AXLE CHASSIS



### 9 Trucks

To Choose From  
YOUR CHOICE

**\$55,000**

Cummins ISX Engines, 18-speed trans. (RTLO18918B), Single speed Eaton rear-ends 4:10 or 4:11 gears w/locker, **Hendrickson Haul-max walking beam susp.**

#2 R087297 2005, D46-170HP rears, 252"WB, 475hp...**\$55,000**

#37 F064740 2004, DSP-463P rears, 253"WB, 475hp...**\$55,000**

#38 R892655 2002, DSP-463P rears, 252"WB, 475hp...**\$55,000**

#51 R892651 2002, DSP-463P rears, 251"WB, 475hp...**\$55,000**

#61 R148685 2006, D46-170HP rears, 253"WB, 475hp...**\$55,000**

#64 R383798 2003, DSP-463P rears, 251"WB, 475hp...**\$55,000**

#112 R892656 2002, DSP-463P rears, 252"WB, 475hp...**\$55,000**

#114 R892657 2002, DSP-463P rears, 252"WB, 475hp...**\$55,000**

#124 R386020 2003, DSP-463P rears, 251"WB, 475hp...**\$55,000**

**CLEAN AND IN EXCELLENT SHAPE!**  
Maintenance Records - Regular Oil Samples  
For More Info: [www.irelandtrucking.com](http://www.irelandtrucking.com)

Thomas H.  
**IRELAND**  
INCORPORATED

Call Charles Ireland  
**541-863-1501**  
Myrtle Creek, OR

## WE OFFER:

- General Truck Repair
- Complete Diesel Engine Service
- Cat - Cummins - Detroit
- Hendrickson Rebush Center

Incl. Hendrickson 380 Series Equalizer Beams

We Rebush Log Trailers

CHALMERS & 8-BAG  
KENWORTH SUSPENSION  
REBUSHES

• Stop By Our Shop •

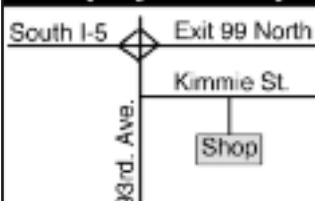

**COMPLETE  
LOWER  
REBUSH**

**\$1575**

Bar Pins Extra

Usually in 3 Hours or less  
Call For Appointment



## SCHELLER DIESEL SERVICE

9144 Kimmie Street - Olympia, WA. 98502 • (360) 943-9818

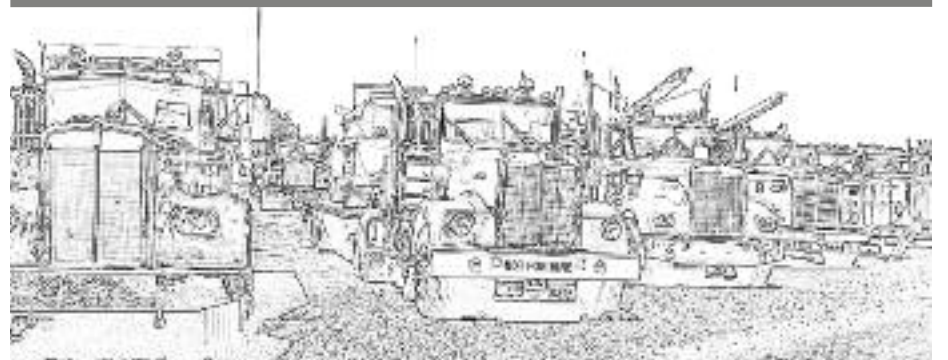





## SILVER CREAM BAKING POWDER

At one time in our history the timber industry was looked upon favorably by society as a whole. It did not have the tarnished image that developed in the 1980's, '90's and in the early 2000's. Before then, logging images were used in advertising by many companies to promote their products. This one, a direct mailer sent primarily to women, encouraged the use of their baking powder in things like "tea cakes," a non-logger food. Tea cakes were baked as a fancy little pastry for neighborhood women to enjoy at their tea socials.

## BLAST FROM THE PAST CONTACT QUINN

ktmurk@centurylink.net

Or by Mail at:

P.O. Box 319,  
Siletz, OR 97380

**Call  
Cleta Gannon**

**541-928-3483  
541-223-1665**

31914 ROLLAND DRIVE  
TANGENT, OR 97389

**REDUCED TO  
\$31,000**



1992 KW T-800, N-14 Cummins, 13 spd.  
with 2 spd. rear ends on pad suspension

## Subscribe Today! LOG TRUCKER

*The magazine about the  
forest products  
transportation industry*

12 Issues – 1 Year Subscription

**\$25<sup>00</sup>**

WA Residents pay \$27.40 w/tax  
Inside U.S.A.



Offer expires  
December 31, 2017

LOG TRUCKER

Send your check or Money order to:  
LOGGERS WORLD LLC  
P. O. Box 1631  
CHEHALIS, WA 98532

☐ \$25.00 for 1-Year Subscription    ☐ \$50.00 for 2-Year Subscription  
WASHINGTON RESIDENTS PAY \$27.40 & \$54.80 w/SALES TAX

NAME:.....

ADDRESS:.....

CITY:..... STATE:..... ZIP:.....

PHONE: (       ).....

(ALLOW 5 WEEKS FOR DELIVERY OF FIRST ISSUE)



# LOG TRUCKER

## DECEMBER 2017

### ADVERTISERS INDEX

A-1 Truck Repair LLC ..17  
 Advanced Hydraulic and  
 Ind. Supply.....6  
 Alpine Industrial LLC...11  
 Gannon Equipment  
 Inc.....19  
 General Trailer .....3  
 Harbor Saw & Supply ..15  
 Idaho Truck Sales .....5

Ireland, Inc. ....18  
 Knox-Douglas, Inc. ....14  
 L&M Truck Sales, Inc...12  
 Lincoln Industrial  
 Supply .....7

LKQ K.C. Truck Parts...20  
 LKQ Wholesale Truck  
 Parts .....9  
 Loadman .....10  
 Log Trucker  
 Subscription .....19  
 Miller Truck Salvage  
 LLC .....15  
 Scheller Diesel Service18  
 Schott Parts &  
 Accessories.....6

St. Johns Truck &  
 Equipment .....8  
 The Gear Box Inc. ....4  
 Tim Morgan Insurance.14  
 Washington Contract  
 Loggers Assoc.....12  
 Western Peterbilt.....17  
 Whit-Log, Inc. ....13

#### FILTERS

Air • Fuel • Water • Oil • Hydraulic

Gates Hoses & Fittings  
 Lincoln Lubrication Equip.

Open Monday - Friday 7:30 am - 5:30 pm  
 Saturdays 8 am - 1 pm

**Williams Oil Filter Service Co.**  
**WOFSCO, INC.**

1247 Puyallup Ave., Tacoma, WA 98421  
 (253) 627-8163

Toll Free: **1-800-522-1250**

#### FOR SALE



**1953 Kenworth**, has a 262  
 Cummins Motor that runs, has 4X4 trans-  
 mission, Mack bogie Susp., needs  
 restored, 10/20 tires **\$3,000 OBO**

**541-409-4142**



*What can we  
**BUILD**  
 for you?*

**888-222-5201**

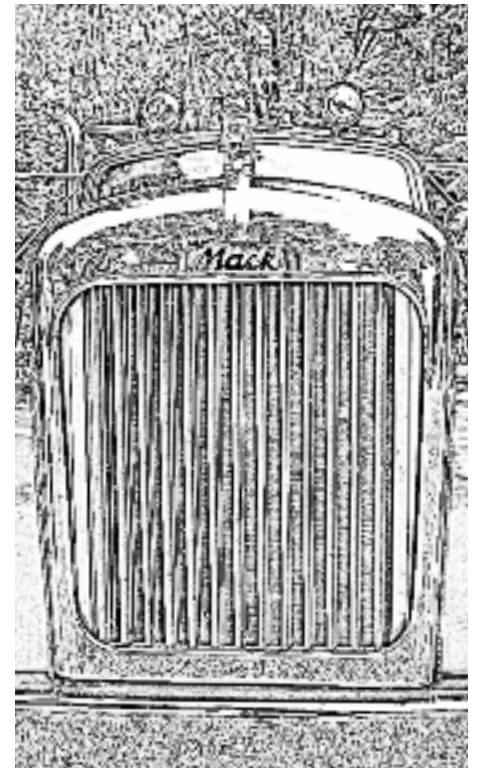

**(800) 622-5170 • (360) 736-3344**

# KC TRUCK PARTS

**183 STATE HWY. 508, NAPA VINE, WA.**  
**www.LKQheavytruck.com**



**2011 PETE 389, ISX 550, RTLO18918B, Air  
 Ride..... PARTING OUT**



**2011 KW T700, ISX15 550, 13 speed,  
 40K rears .....PARTING OUT**



**1999 KW T800, C-12 Cat, 13 speed, 8 bag  
 / 40K rears .....PARTING OUT**



**1998 IH 9100 Fuel Tanker, Cat C-12, 9  
 speed O/D, 40K tandem, 4 compartment  
 3700 gal. w2 reels .....  
 .....SELLING COMPLETE**



**2000 FREIGHTLINER Argosy, 60 series  
 430/470 DDC IV, RTLC16609C, 40K rears .  
 .....PARTING OUT**



**IH 4900 Dump Truck, DT466 (only 39K miles on  
 truck), 10 spd, 40K rears / Spring/Beam, 16 ft.  
 rock box...EASY FIXER/SELLING COMPLETE**